

**NOTES:**

- 1) CONSULT WITH L.D. ON ACCESS FOR POWER TO PRACTICALS INCLUDING SCONCES AND DESK LAMP.
- 2) CONSULT WITH MUSIC DIRECTOR ON PLACEMENT OF BAND.
- 3) KEYBOARD SHOULD BE FITTED INSIDE THE SHELL OF A SPINET PIANO.

THIS DRAWING REPRESENTS VISUAL CONCEPTS AND CONSTRUCTION SUGGESTIONS ONLY. IT DOES NOT REPLACE THE KNOWLEDGE AND ADVICE OF A LICENSED STRUCTURAL ENGINEER. THE DESIGNER IS UNQUALIFIED TO DETERMINE THE STRUCTURAL APPROPRIATENESS OF THIS DESIGN AND WILL NOT ASSUME RESPONSIBILITY FOR IMPROPER ENGINEERING OR USE.

BRAD STEINMETZ  
 (c) 614-749-0240  
 bradsteinmetz@gmail.com

**CATCO**

STUDIO TWO

**DADDY LONG LEGS**

DIRECTION: S. ANDERSON  
 DESIGN: B. STEINMETZ  
 ASST DES: B. BIEDENBACH  
 TECH DIR: J. WOLFLE

SCALE:  
 1/2" = 1'-0"

DRAWING:  
 1 OF 6

DATE:  
 12-15-2017

REVISION:  
 01

**GROUND PLAN**

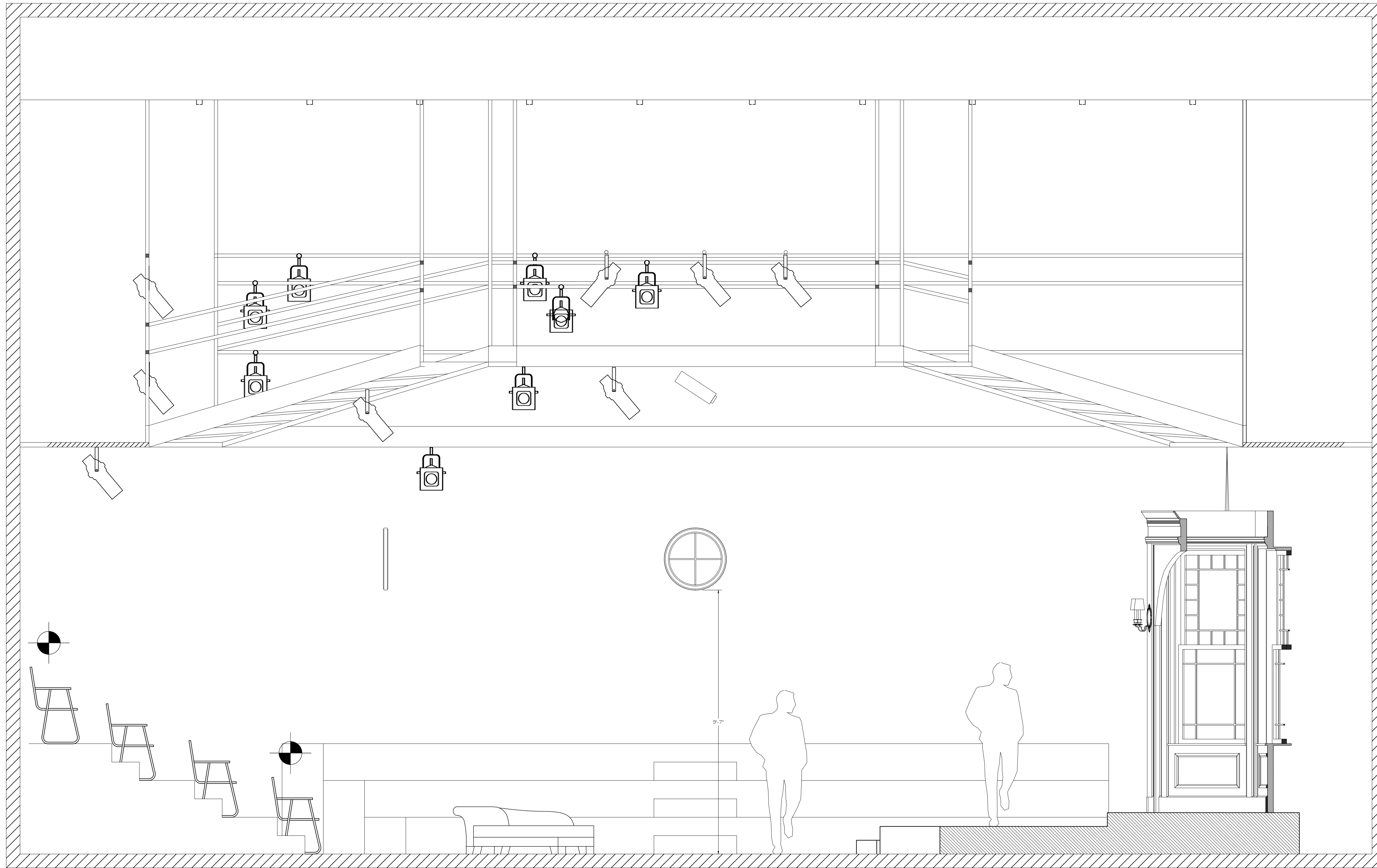

1 A-A SECTION  
2 SCALE: 1/2" = 1'-0"

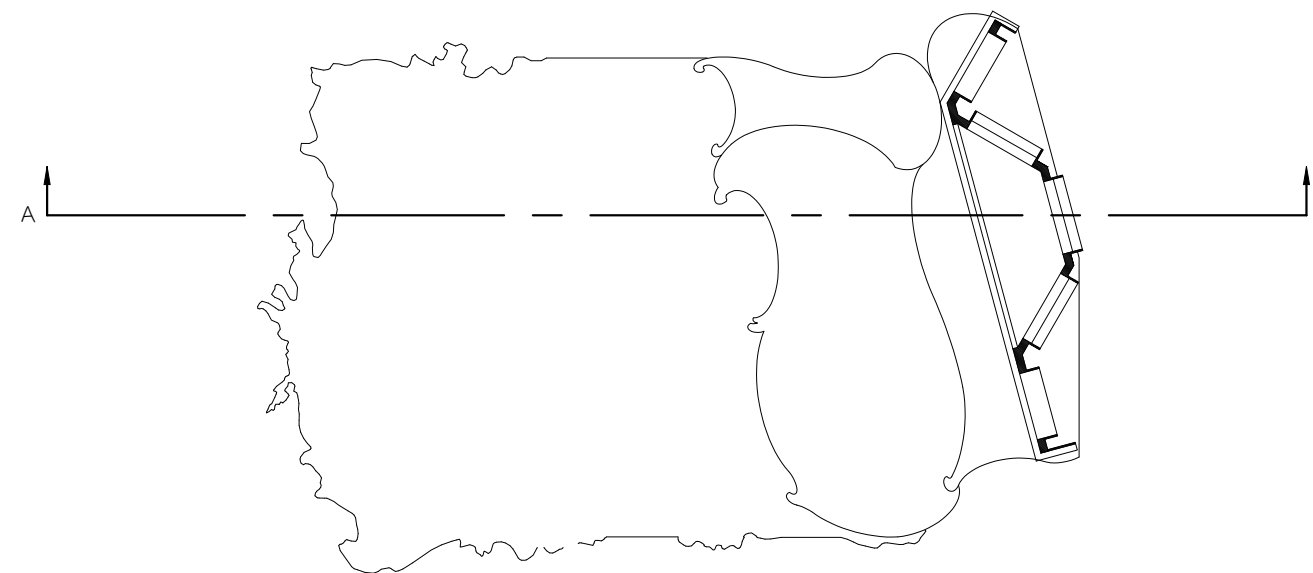

2 GROUND PLAN WITH SECTION LINE  
2 NOT TO SCALE

NOTES:

- 1) WINDOWS SHOULD BE HUNG WITH MINIMAL VISIBLE HARDWARE.
- 2) CONSULT WITH S.D. & L.D. ON EXACT PLACEMENT OF WINDOWS.

THIS DRAWING REPRESENTS VISUAL CONCEPTS AND CONSTRUCTION SUGGESTIONS ONLY. IT DOES NOT REPLACE THE KNOWLEDGE AND ADVICE OF A LICENSED STRUCTURAL ENGINEER. THE DESIGNER IS UNQUALIFIED TO DETERMINE THE STRUCTURAL APPROPRIATENESS OF THIS DESIGN AND WILL NOT ASSUME RESPONSIBILITY FOR IMPROPER ENGINEERING OR USE.

BRAD STEINMETZ  
(c) 614-749-0240  
bradsteinmetz@gmail.com

**CATCO**

STUDIO TWO

DADDY  
LONG LEGS

DIRECTION: S. ANDERSON  
DESIGN: B. STEINMETZ  
ASST DES: B. BIEDENBACH  
TECH DIR: J. WOLFLE

SCALE:  
1/2" = 1'-0"

DRAWING:  
2 OF 6

DATE:  
12-15-2017

REVISION:  
01

STAGE SECTION

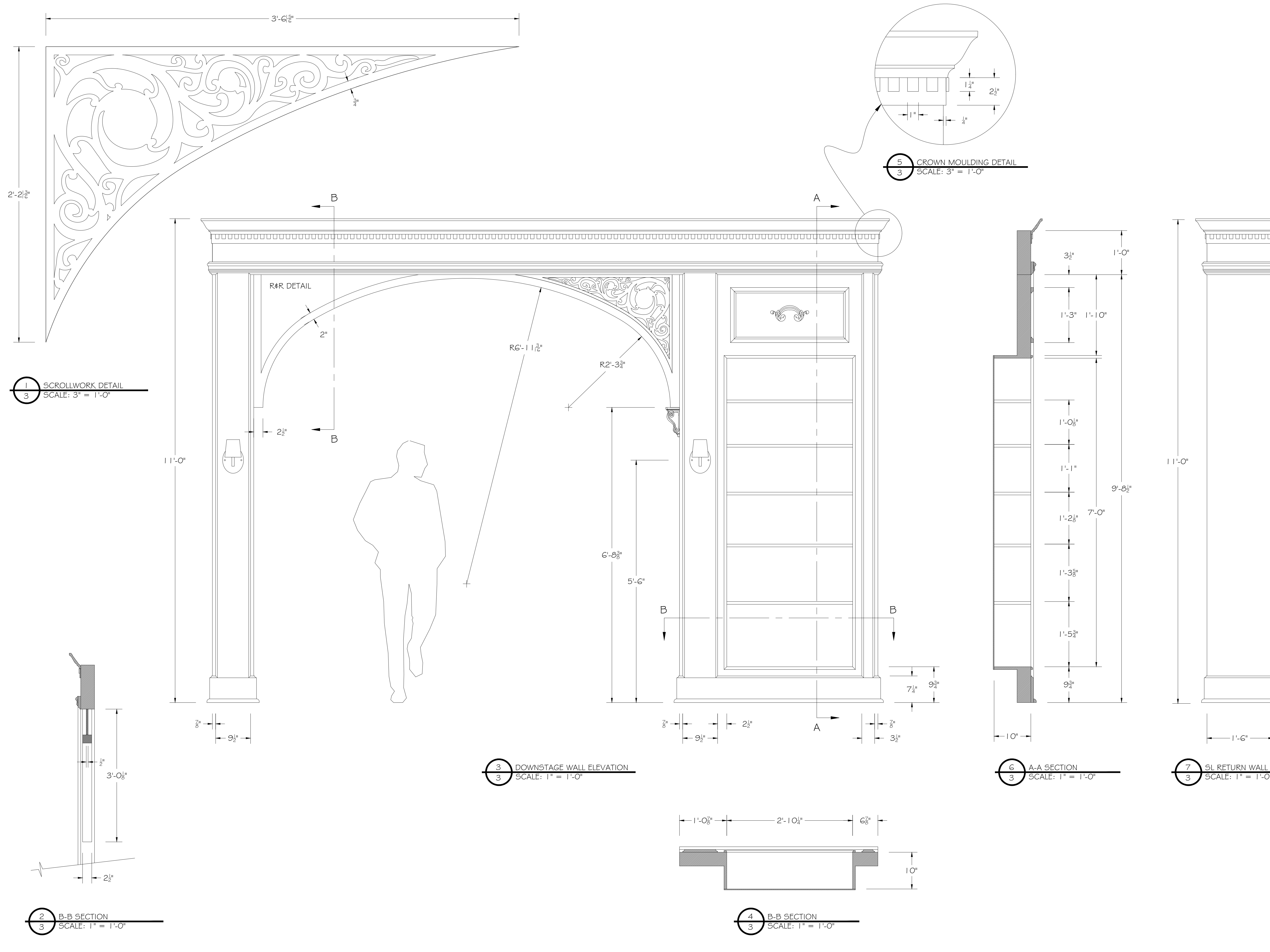

- NOTES:**
- 1) CONSULT WITH S.D. ON ANY MOULDING SUBSTITUTIONS.
  - 2) REVERSE AND REPEAT DETAILS ON SCROLLWORK AND CORBELS.
  - 3) CONSULT WITH S.D. AND L.D. ON PRACTICAL SCANCES.
  - 4) BOOKSHELF SHOULD SUPPORT WEIGHT OF ACTUAL BOOKS.
  - 5) WALLS SHOULD BE FILLED, SANDED AND READY FOR PAINT.
  - 6) MOULDING LINKS:
    - 5-1/4" CROWN MOULDING <https://goo.gl/vNtiU>
    - 2-5/8" CHAIR RAIL MOULDING <https://goo.gl/wTVcI>
    - QUARTER ROUND MOULDING <https://goo.gl/npXp9L>
    - APPLIQUES ON PANELING <https://goo.gl/9sUC8b>
    - DECORATIVE CORBELS <https://goo.gl/YNBwVj>

THIS DRAWING REPRESENTS VISUAL CONCEPTS AND CONSTRUCTION SUGGESTIONS ONLY. IT DOES NOT REPLACE THE KNOWLEDGE AND ADVICE OF A LICENSED STRUCTURAL ENGINEER. THE DESIGNER IS UNQUALIFIED TO DETERMINE THE STRUCTURAL APPROPRIATENESS OF THIS DESIGN AND WILL NOT ASSUME RESPONSIBILITY FOR IMPROPER ENGINEERING OR USE.

BRAD STEINMETZ  
 (c) 614-749-0240  
 bradsteinmetz@gmail.com

**CATCO**  
 STUDIO TWO

**DADDY LONG LEGS**

DIRECTION: S. ANDERSON  
 DESIGN: B. STEINMETZ  
 ASST DES: B. BIEDENBACH  
 TECH DIR: J. WOLFLE

SCALE: 1" = 1'-0"	DRAWING: 3 OF 6
DATE: 12-15-2017	REVISION: 01

DS WALL ELEVATIONS

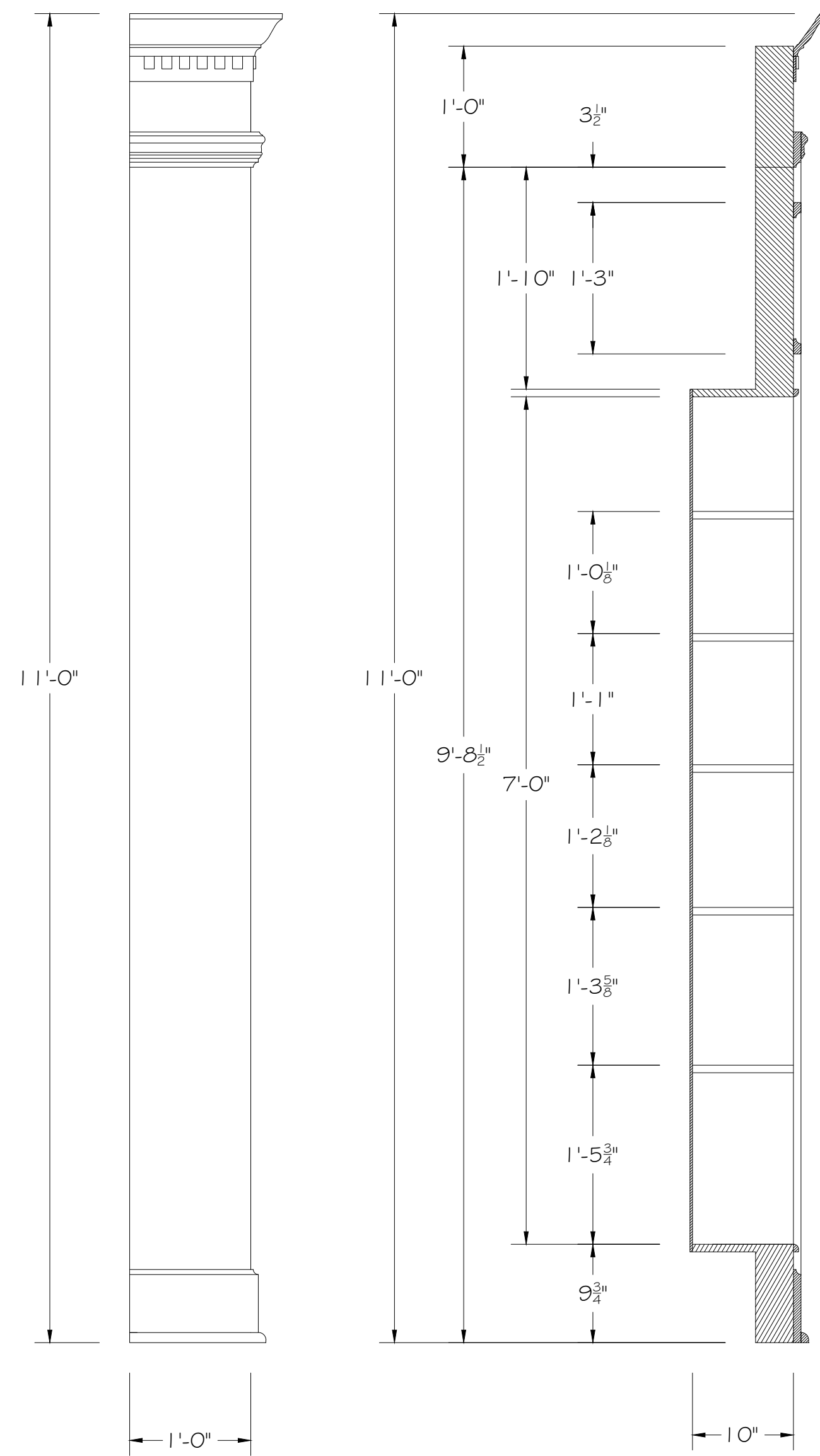

1 SR RETURN WALL  
SCALE: 1" = 1'-0"

2 A-A SECTION  
SCALE: 1" = 1'-0"

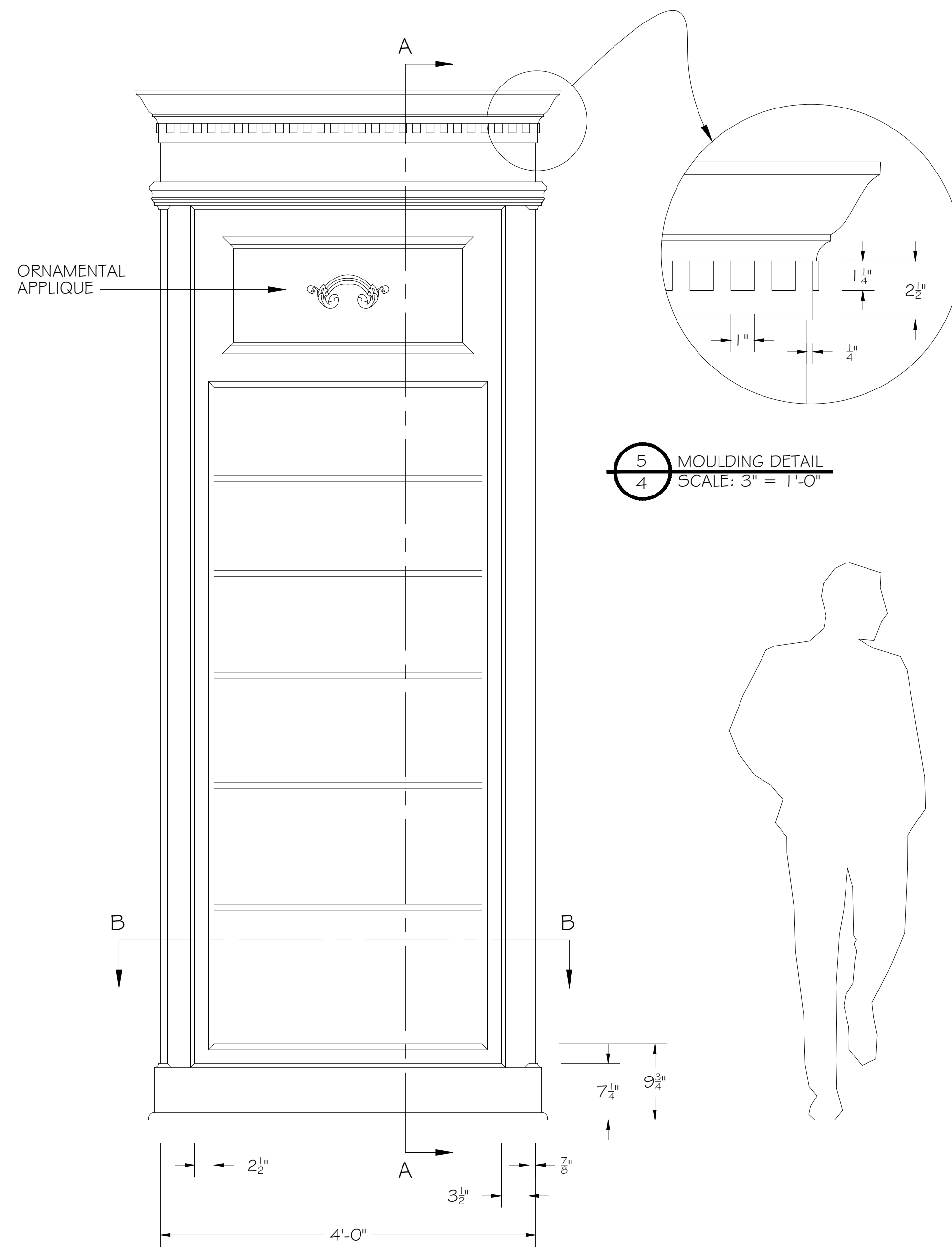

5 MOULDING DETAIL  
SCALE: 3" = 1'-0"

3 SR BOOKSHELF ELEVATION  
SCALE: 1" = 1'-0"

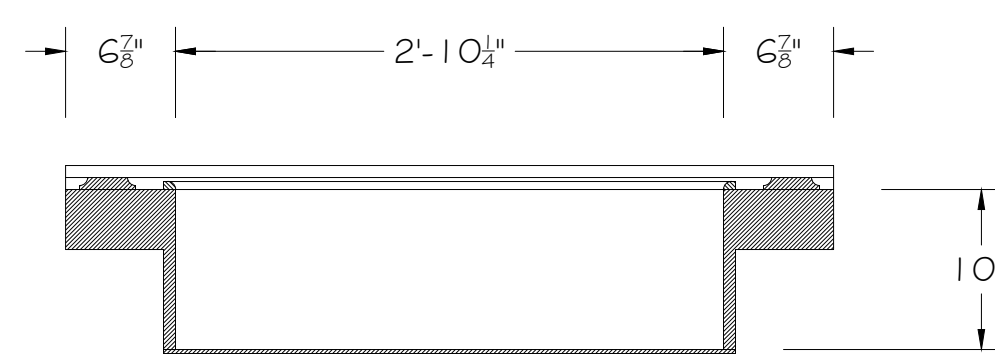

4 B-B SECTION  
SCALE: 1" = 1'-0"

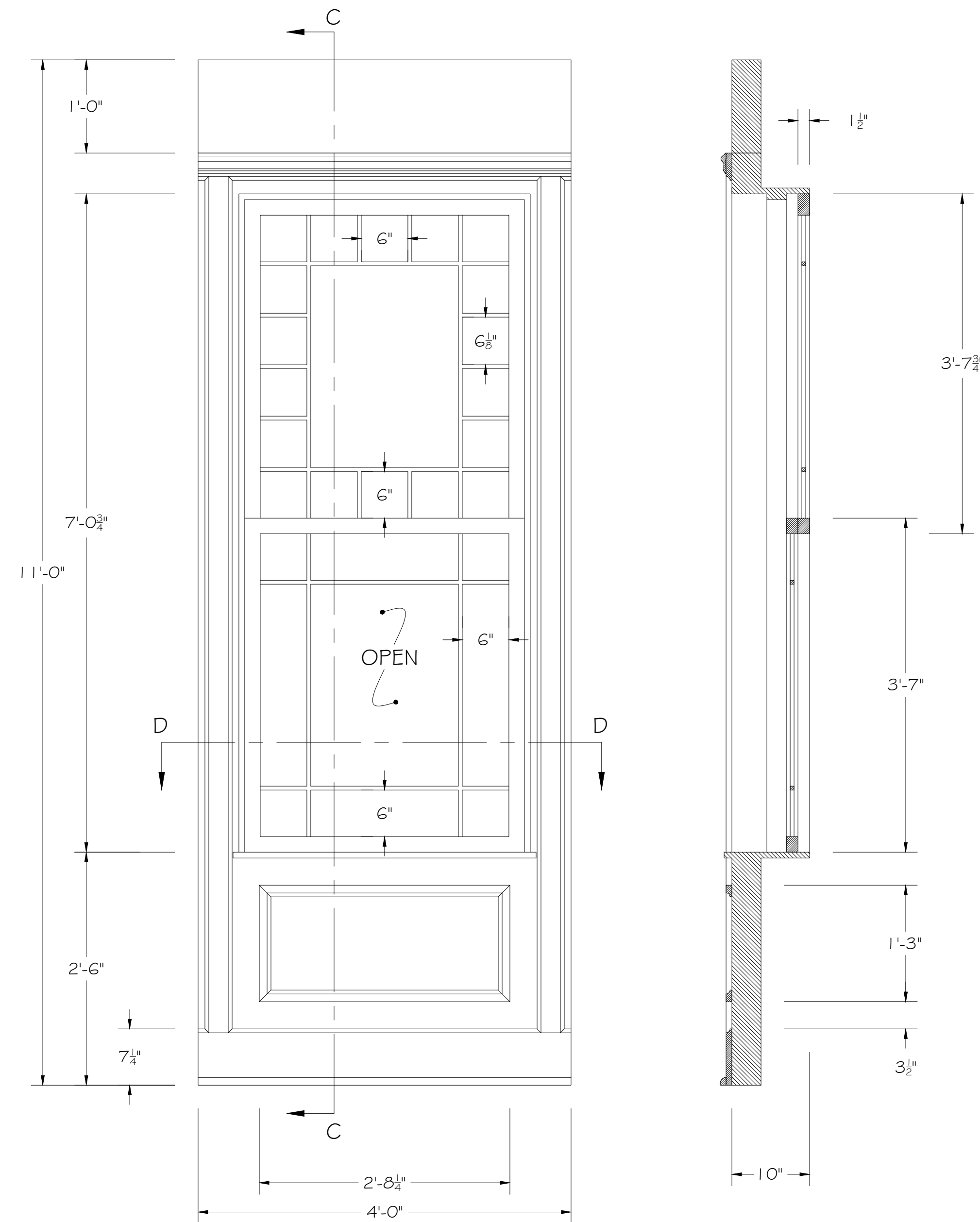

6 WINDOW ELEVATION (BUILD 3)  
SCALE: 1" = 1'-0"

8 C-C SECTION  
SCALE: 1" = 1'-0"

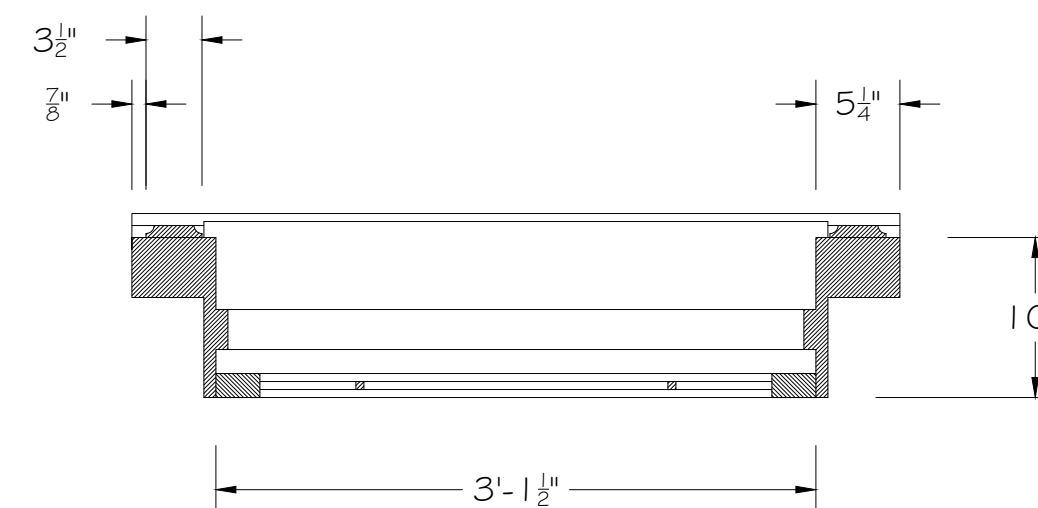

7 D-D SECTION  
SCALE: 1" = 1'-0"

NOTES:

- 1) BOOKSHELF SHOULD SUPPORT WEIGHT OF ACTUAL BOOKS.
- 2) CONSULT WITH S.D. ON ANY MOULDING SUBSTITUTIONS.
- 3) IF NECESSARY, WINDOW CONSTRUCTION CAN BE SIMPLIFIED. CONSULT WITH S.D. IF DESIRED.
- 4) MUSLIN SHOULD BE ADDED TO THE UPSTAGE SIDE OF WINDOWS IN CONSULTATION WITH L.D.
- 5) WALLS & WINDOWS SHOULD BE FILLED, SANDED AND READY FOR PAINT.

THIS DRAWING REPRESENTS VISUAL CONCEPTS AND CONSTRUCTION SUGGESTIONS ONLY. IT DOES NOT REPLACE THE KNOWLEDGE AND ADVICE OF A LICENSED STRUCTURAL ENGINEER. THE DESIGNER IS UNQUALIFIED TO DETERMINE THE STRUCTURAL APPROPRIATENESS OF THIS DESIGN AND WILL NOT ASSUME RESPONSIBILITY FOR IMPROPER ENGINEERING OR USE.

BRAD STEINMETZ  
(c) 614-749-0240  
bradsteinmetz@gmail.com

**CATCO**

STUDIO TWO

DADDY  
LONG LEGS

DIRECTION: S. ANDERSON  
DESIGN: B. STEINMETZ  
ASST DES: B. BIEDENBACH  
TECH DIR: J. WOLFLE

SCALE:

1" = 1'-0"

DATE:  
12-15-2017

DRAWING:

4 OF 6

REVISION:

01

US WALL ELEVATIONS

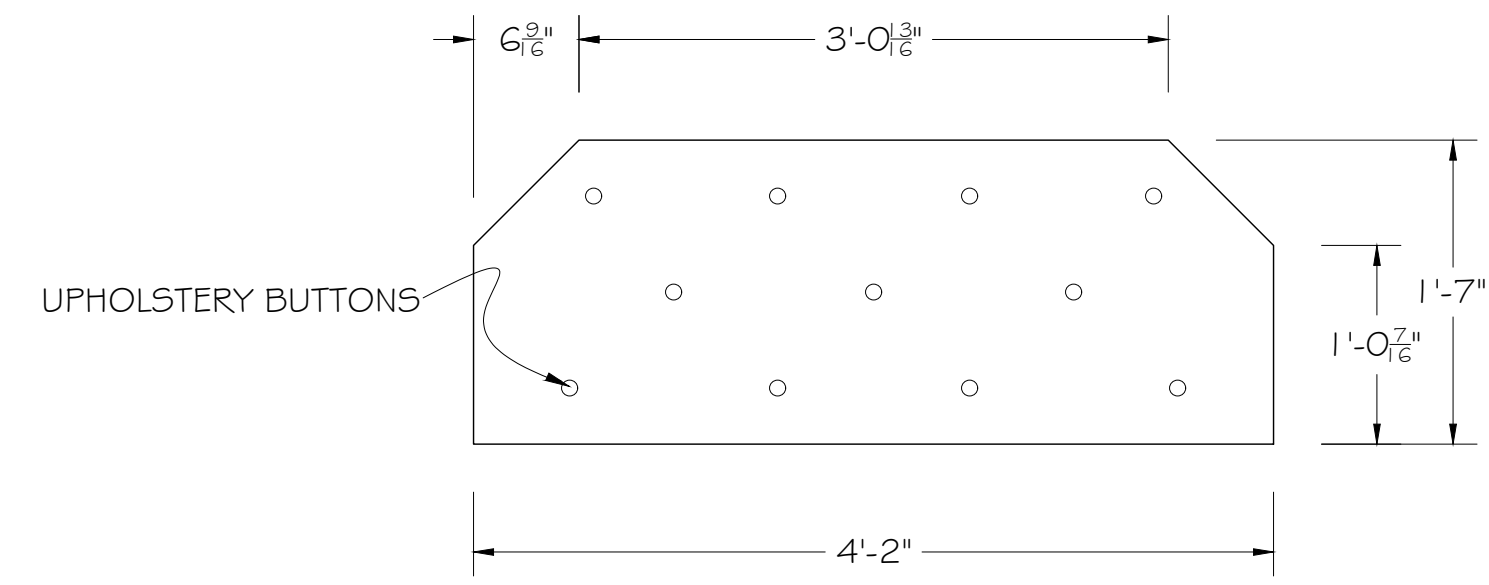

1 WINDOW SEAT LID  
5 SCALE: 1" = 1'-0"

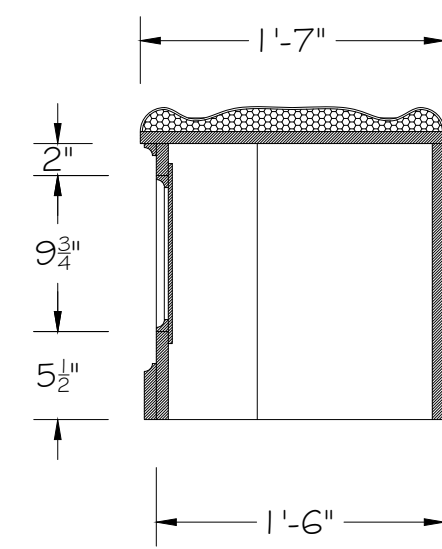

2 A-A SECTION  
5 SCALE: 1" = 1'-0"

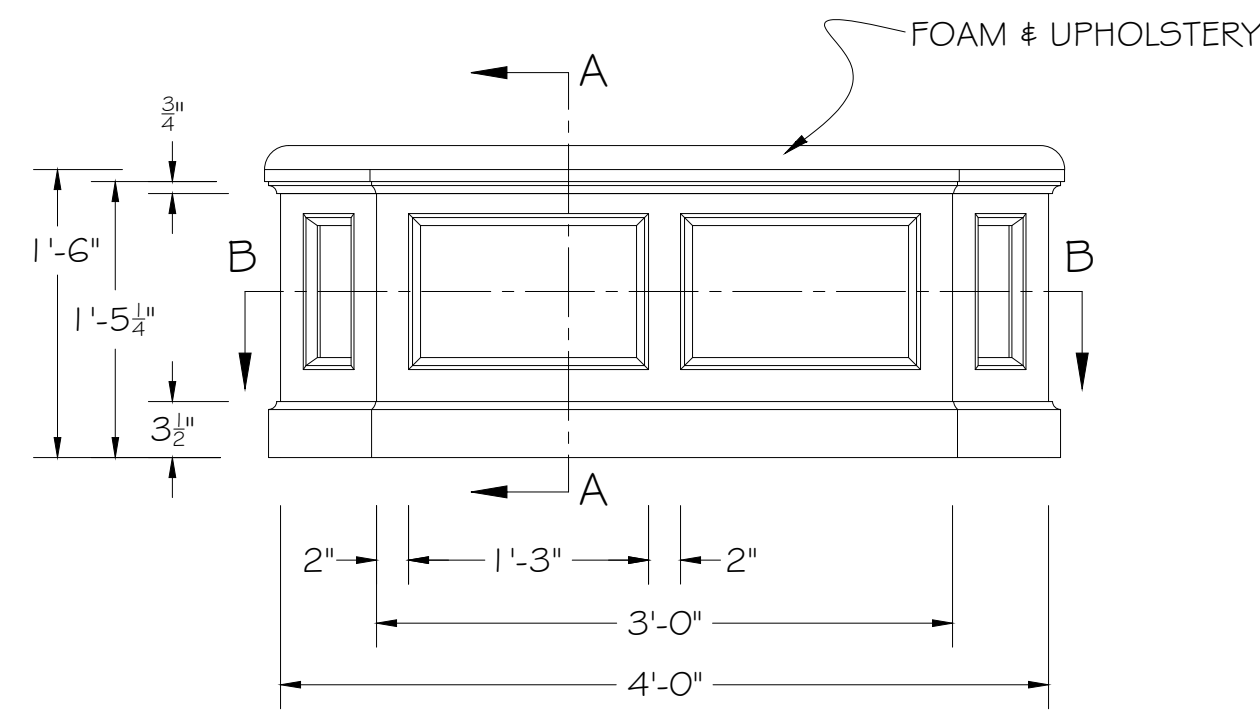

3 WINDOW SEAT FRONT  
5 SCALE: 1" = 1'-0"

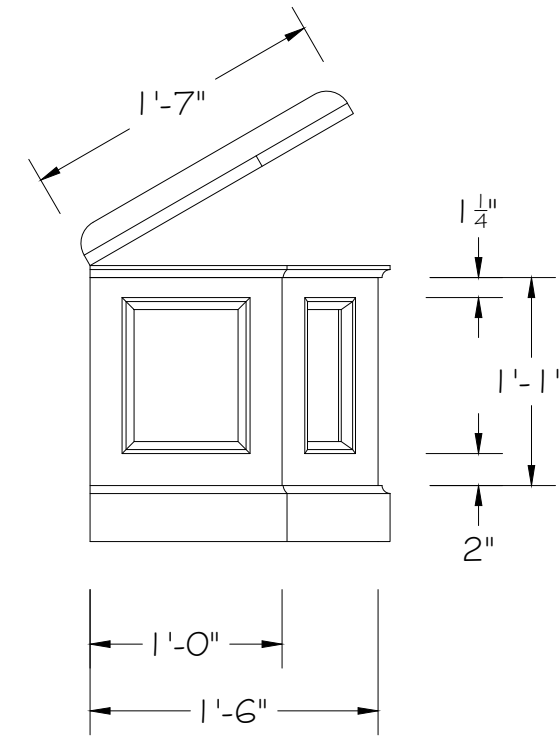

4 WINDOW SEAT SIDE  
5 SCALE: 1" = 1'-0"

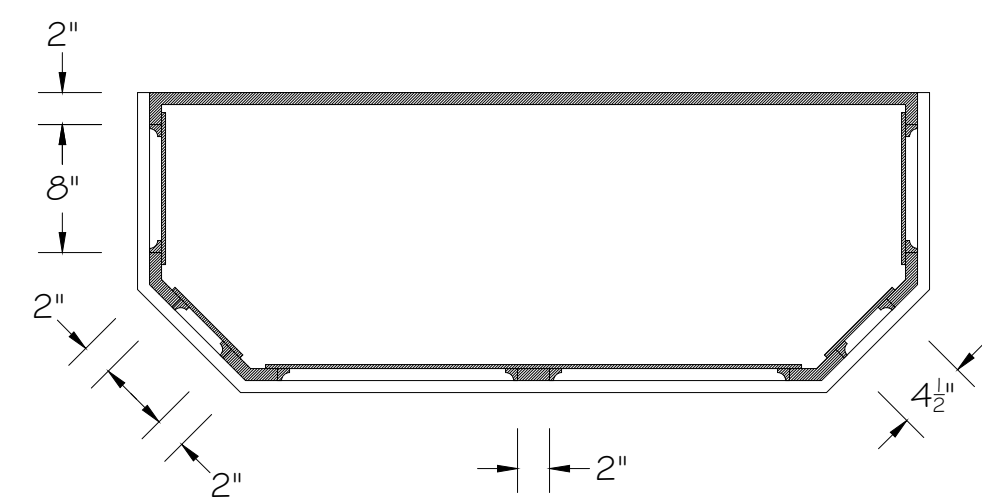
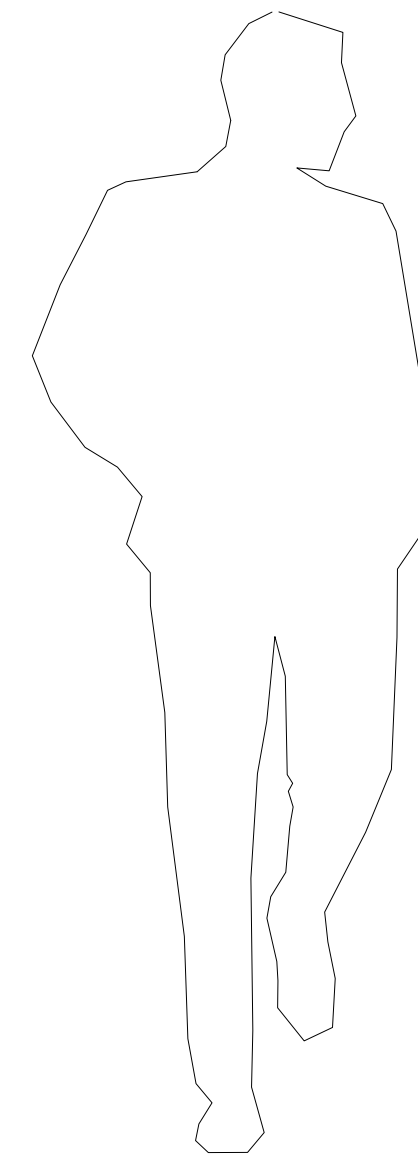

5 B-B SECTION  
5 SCALE: 1" = 1'-0"

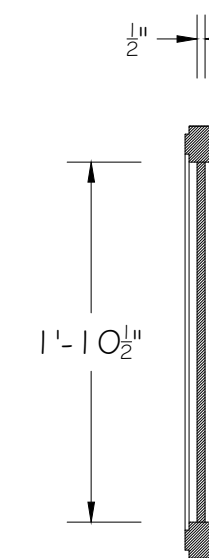

6 C-C SECTION  
5 SCALE: 1" = 1'-0"

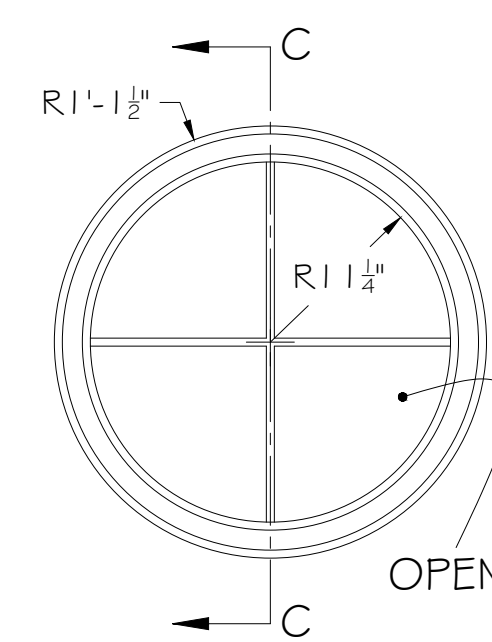

7 HANGING WINDOW (BUILD 3)  
5 SCALE: 1" = 1'-0"

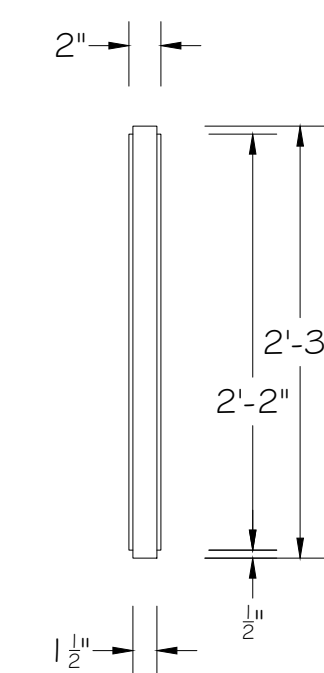

8 HANGING WINDOW END  
5 SCALE: 1" = 1'-0"

NOTES:

- 1) LID OF WINDOW SEAT WILL HINGE OPEN TO ACCOMMODATE STORAGE FOR PROPS & COSTUME PIECES. HINGES SHOULD BE HIDDEN UNDER THE LID.
- 2) CONSULT WITH S.D. FOR ANY MOULDING SUBSTITUTIONS.
- 3) WINDOW SEAT SHOULD SUPPORT ACTORS STANDING OR SITTING.
- 4) WINDOWS ARE OPEN WITH NO GLASS.
- 5) WINDOW SEAT & WINDOWS SHOULD BE FILLED, SANDED AND READY FOR PAINT.
- 6) MOULDING LINKS:
  - COVE MOULDING  
<https://goo.gl/AxaeUX>
  - BASE MOULDING: ROUTED 1X OR  
<https://goo.gl/s5hVA8>

THIS DRAWING REPRESENTS VISUAL CONCEPTS AND CONSTRUCTION SUGGESTIONS ONLY. IT DOES NOT REPLACE THE KNOWLEDGE AND ADVICE OF A LICENSED STRUCTURAL ENGINEER. THE DESIGNER IS UNQUALIFIED TO DETERMINE THE STRUCTURAL APPROPRIATENESS OF THIS DESIGN AND WILL NOT ASSUME RESPONSIBILITY FOR IMPROPER ENGINEERING OR USE.

BRAD STEINMETZ  
(c) 614-749-0240  
bradsteinmetz@gmail.com

**CATCO**

STUDIO TWO

DADDY  
LONG LEGS

DIRECTION: S. ANDERSON  
DESIGN: B. STEINMETZ  
ASST DES: B. BIEDENBACH  
TECH DIR: J. WOLFLE

SCALE: 1" = 1'-0"	DRAWING: 5 OF 6
DATE: 12-15-2017	REVISION: 01

DETAIL DRAWINGS

1  
6 PLATFORMING PLAN  
SCALE: 1" = 1'-0"



2  
6 PLATFORMING ELEVATION  
SCALE: 1" = 1'-0"

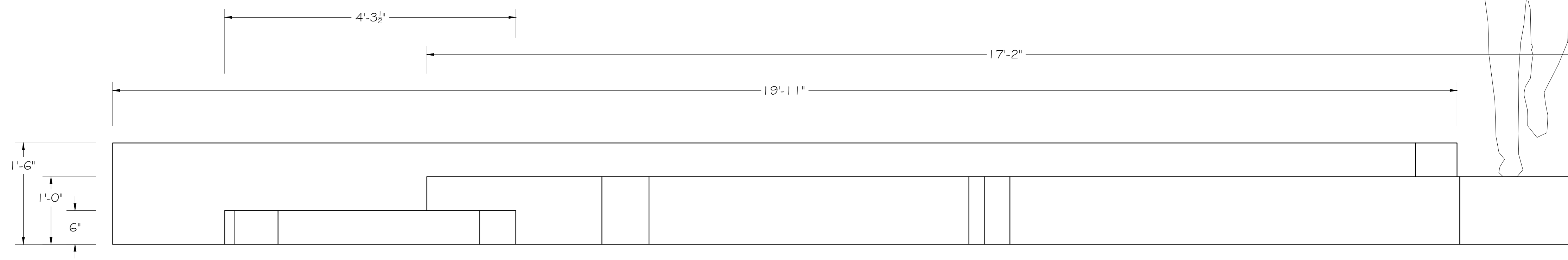

NOTES:

- 1) AREA OF UPPER PLATFORM UPSTAGE OF WINDOWS SHOULD BE LEFT AS LOW AS POSSIBLE TO BE USED AS LIGHTING POSITIONS.
- 2) CONSULT WITH S.D. ON METHODS FOR ACHIEVING CURVES.
- 3) FACINGS FOR PLATFORMS SHOULD FOLLOW CURVES SEAMLESSLY. ADDITIONAL CARE MAY BE NECESSARY WHERE FACINGS INTERSECT.
- 4) FACINGS SHOULD BE FILLED, SANDED AND READY FOR PAINT.
- 5) CONSULT WITH L.D. ON ACCESS FOR POWER TO PRACTICALS INCLUDING A DESK LAMP.

THIS DRAWING REPRESENTS VISUAL CONCEPTS AND CONSTRUCTION SUGGESTIONS ONLY. IT DOES NOT REPLACE THE KNOWLEDGE AND ADVICE OF A LICENSED STRUCTURAL ENGINEER. THE DESIGNER IS UNQUALIFIED TO DETERMINE THE STRUCTURAL APPROPRIATENESS OF THIS DESIGN AND WILL NOT ASSUME RESPONSIBILITY FOR IMPROPER ENGINEERING OR USE.

BRAD STEINMETZ  
(c) 614-749-0240  
bradsteinmetz@gmail.com

**CATCO**

STUDIO TWO

DADDY  
LONG LEGS

DIRECTION: S. ANDERSON  
DESIGN: B. STEINMETZ  
ASST DES: B. BIEDENBACH  
TECH DIR: J. WOLFLE

SCALE: 1" = 1'-0"	DRAWING: 6 OF 6
DATE: 12-15-2017	REVISION: 01

PLATFORMING



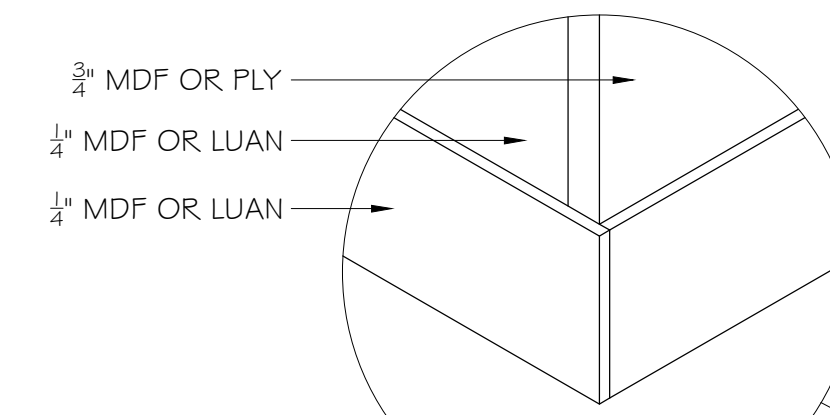
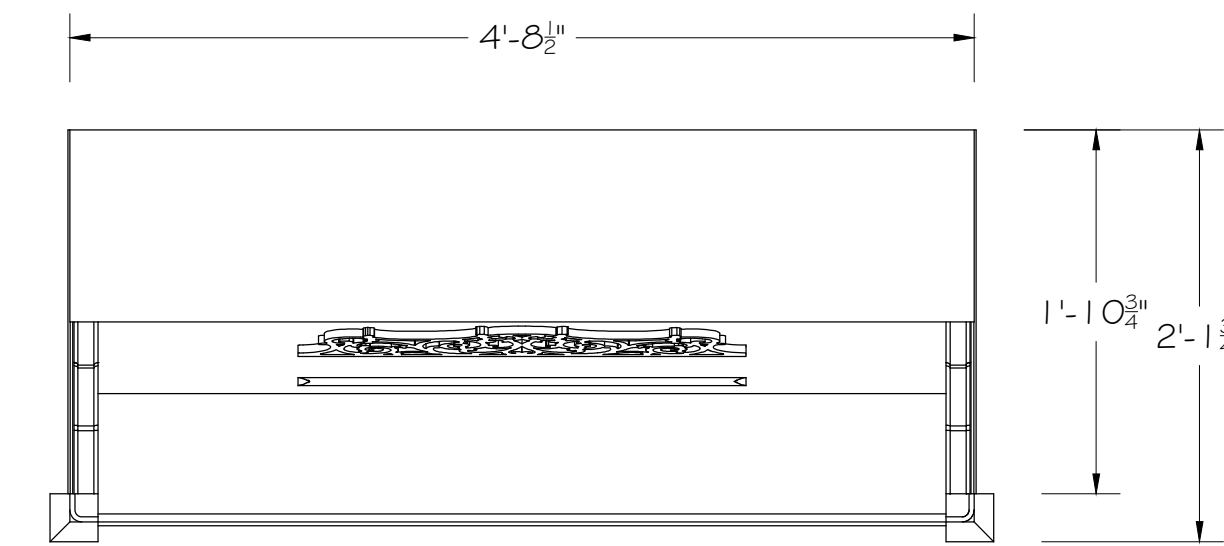
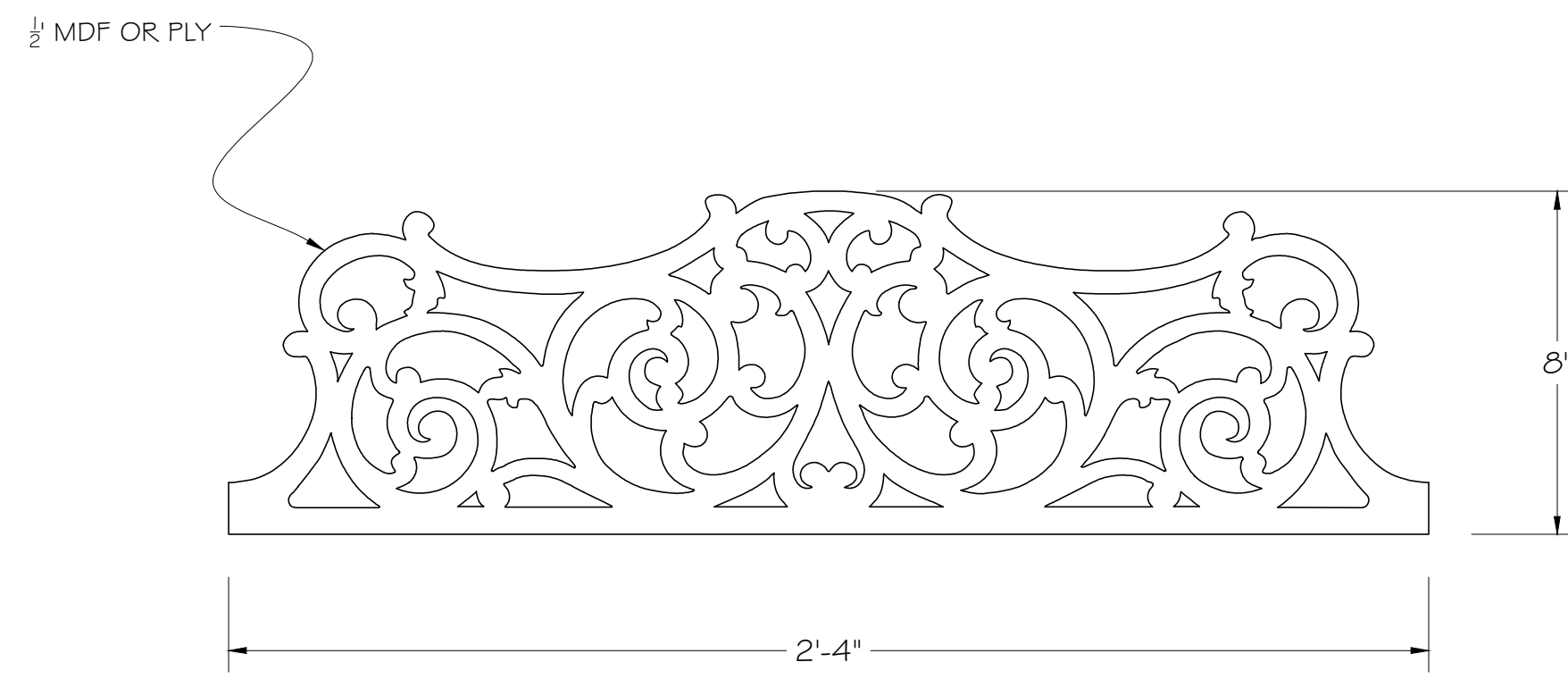
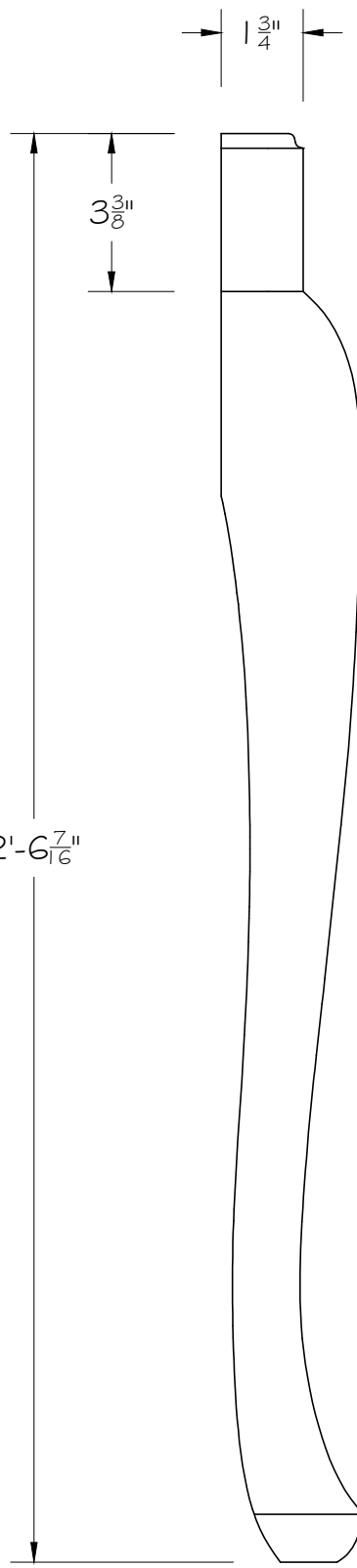
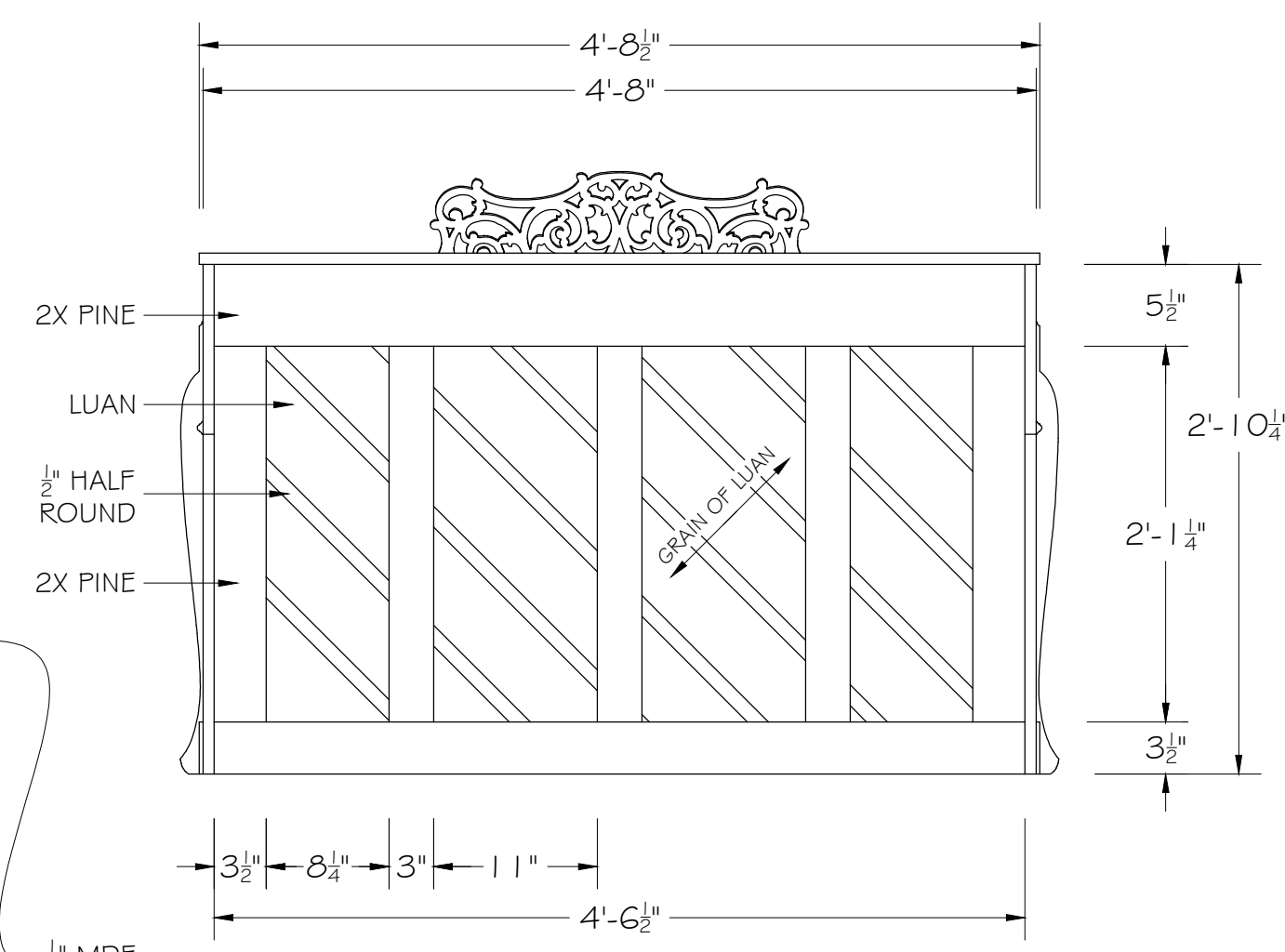
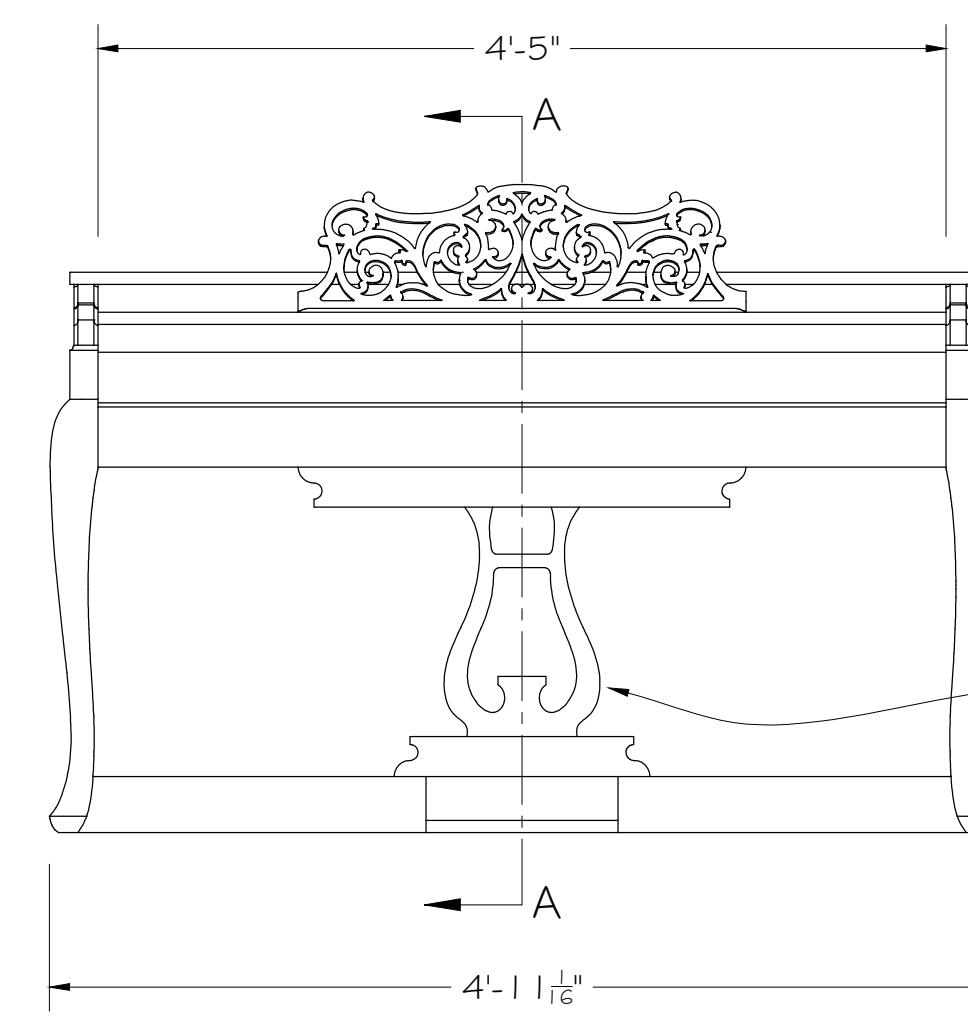
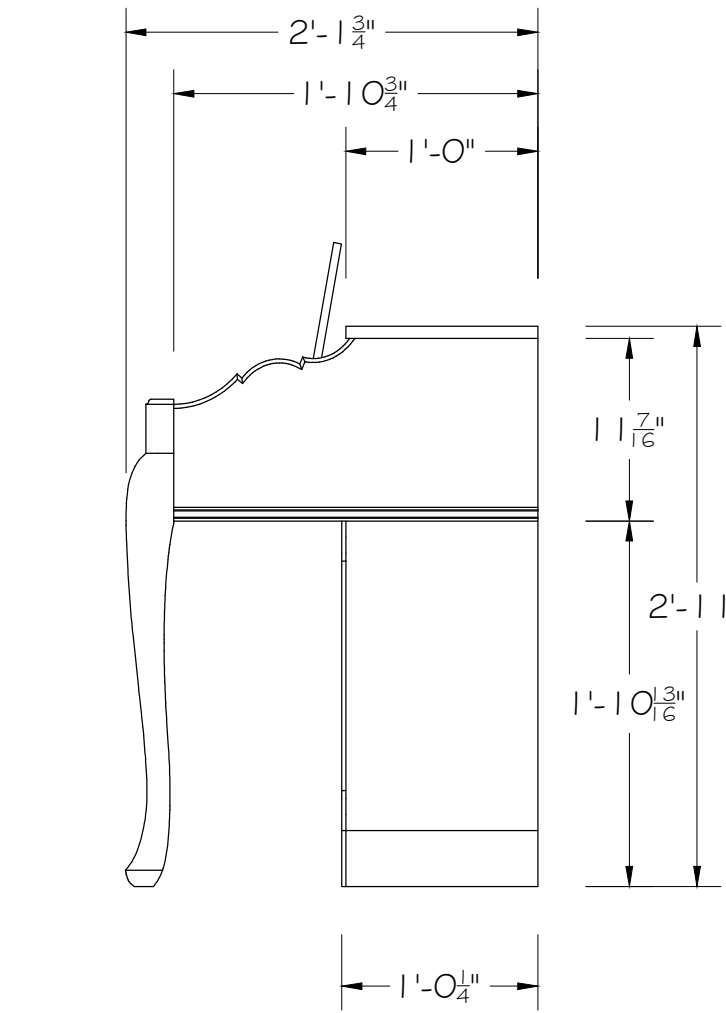
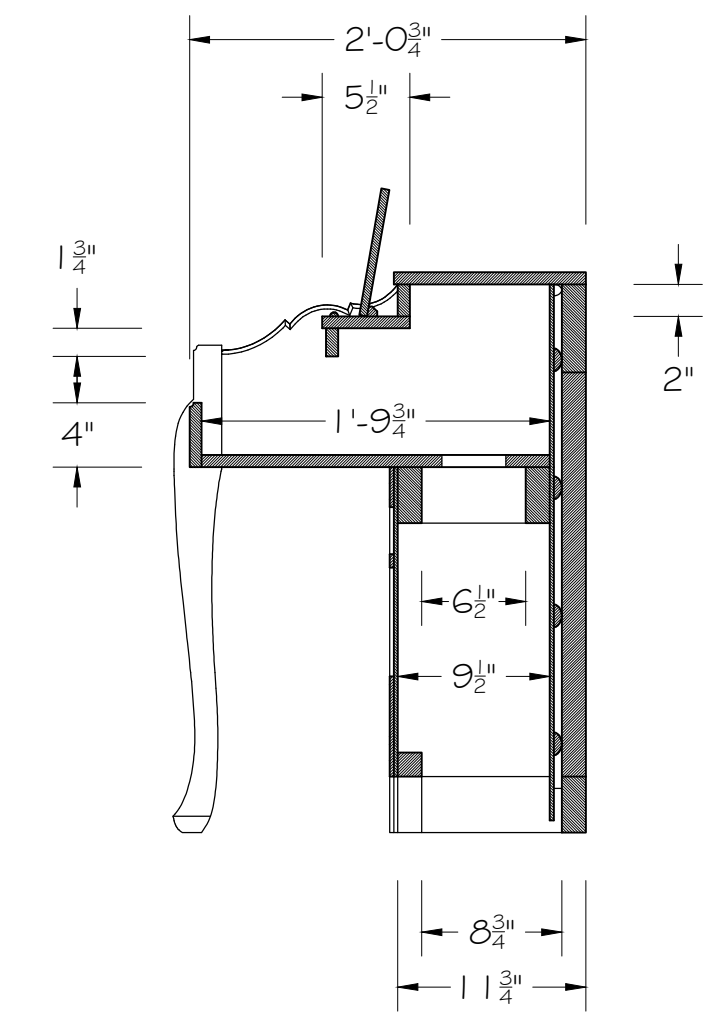
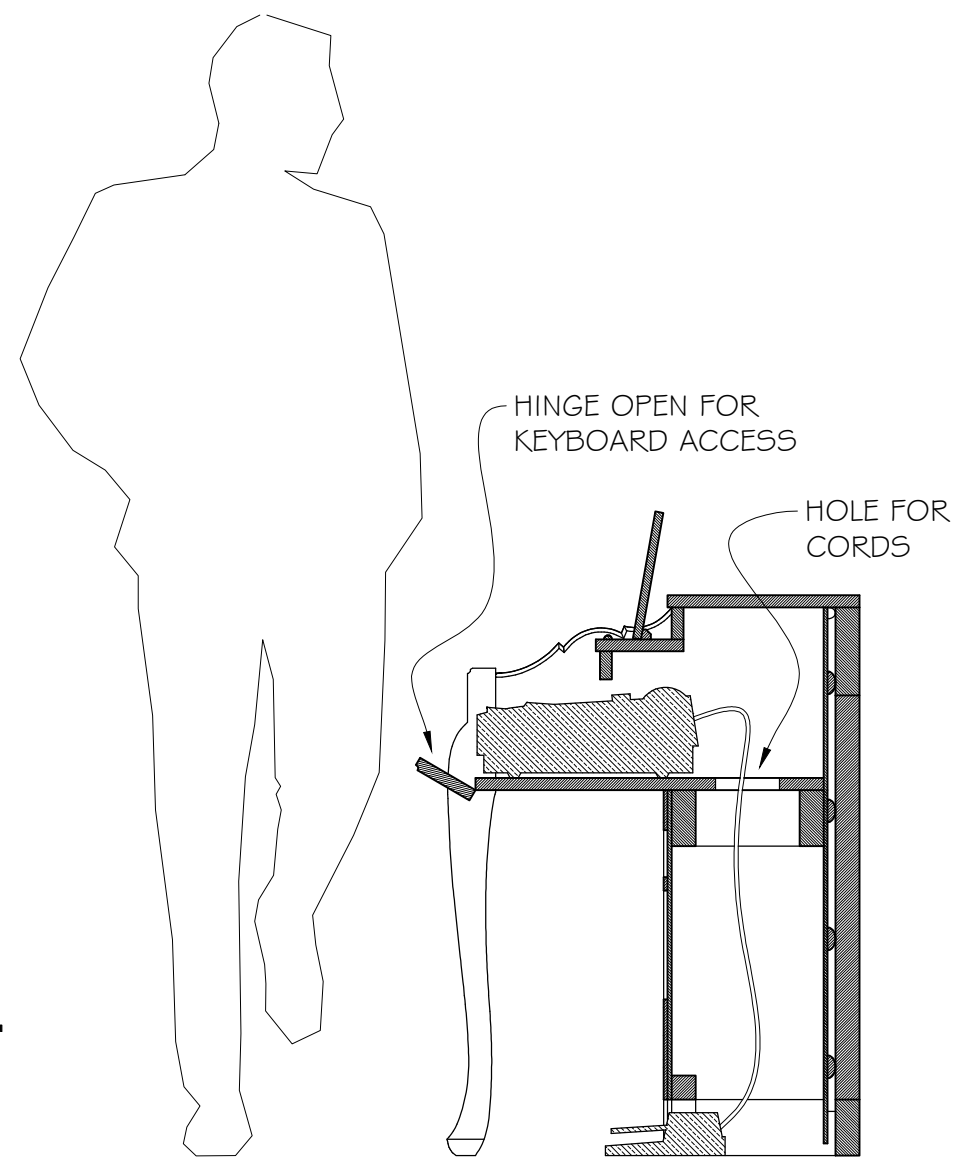
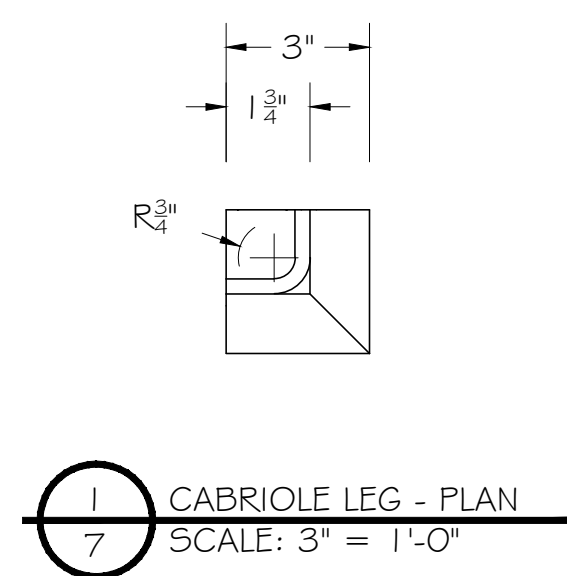

7 CABRIOLE LEG - ELEVATION  
SCALE: 3" = 1'-0"

8 MUSIC HOLDER - ELEVATION  
SCALE: 3" = 1'-0"

9 PLAN VIEW  
SCALE: 1" = 1'-0"

10 CORNER ISOMETRIC  
SCALE: 3" = 1'-0"

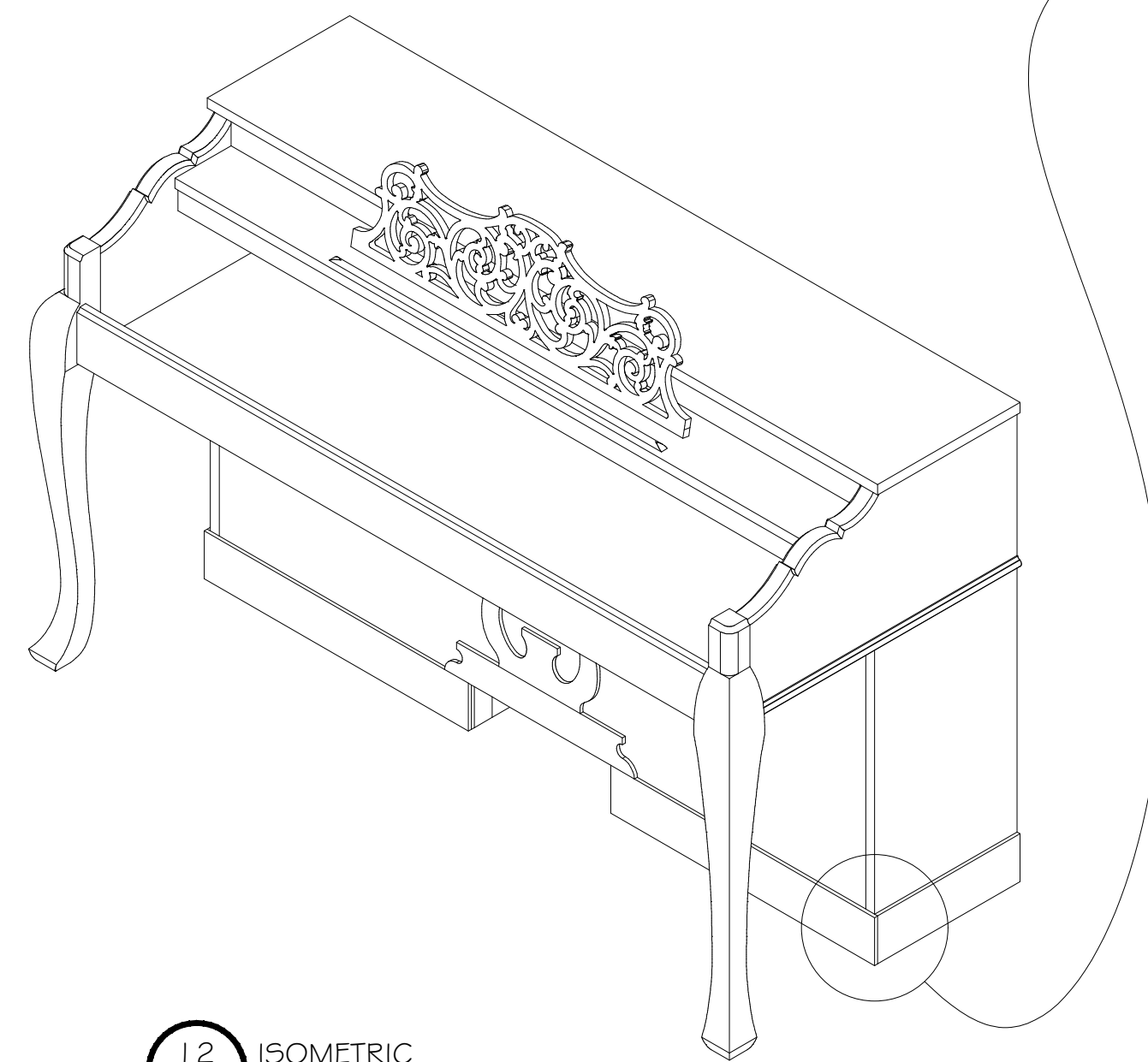
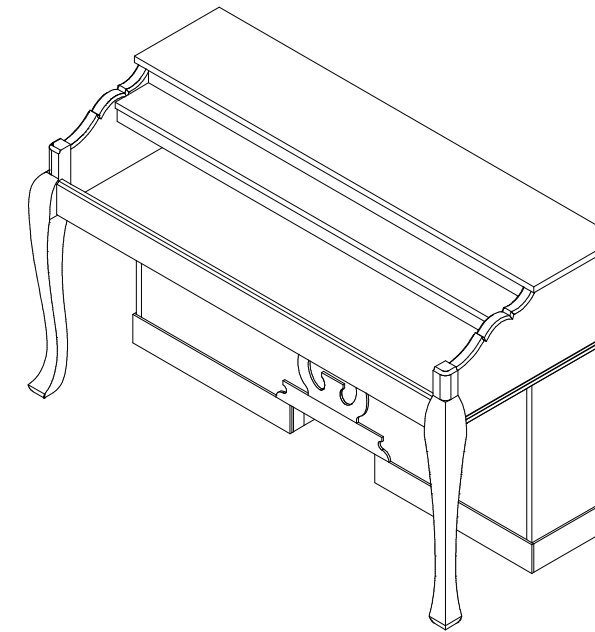
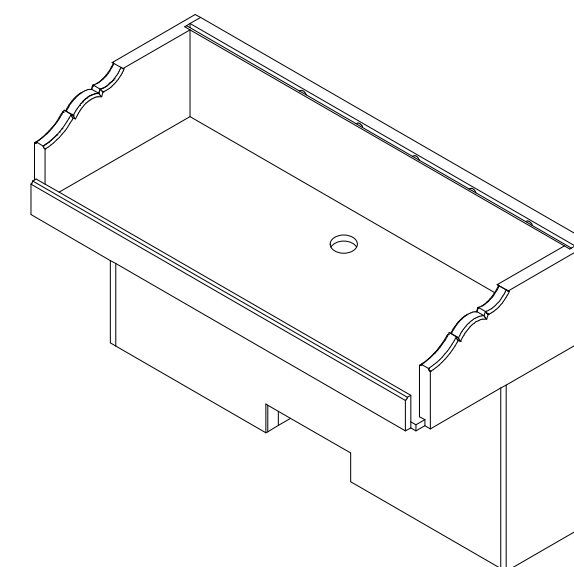
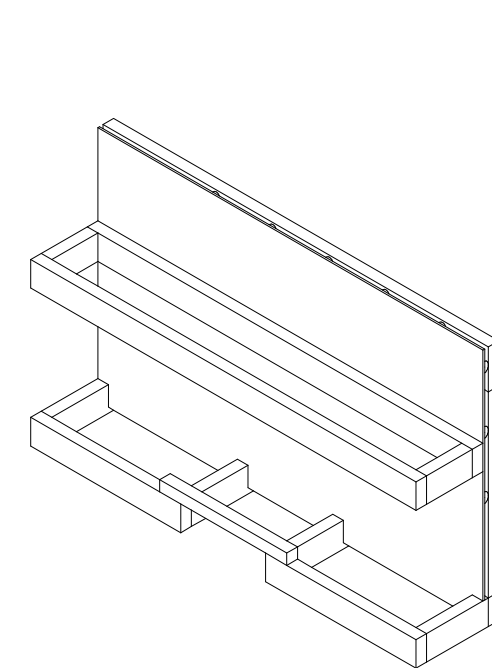
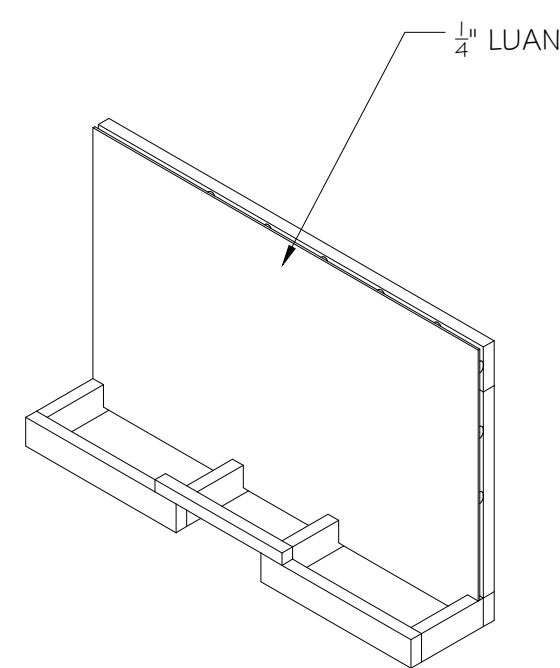
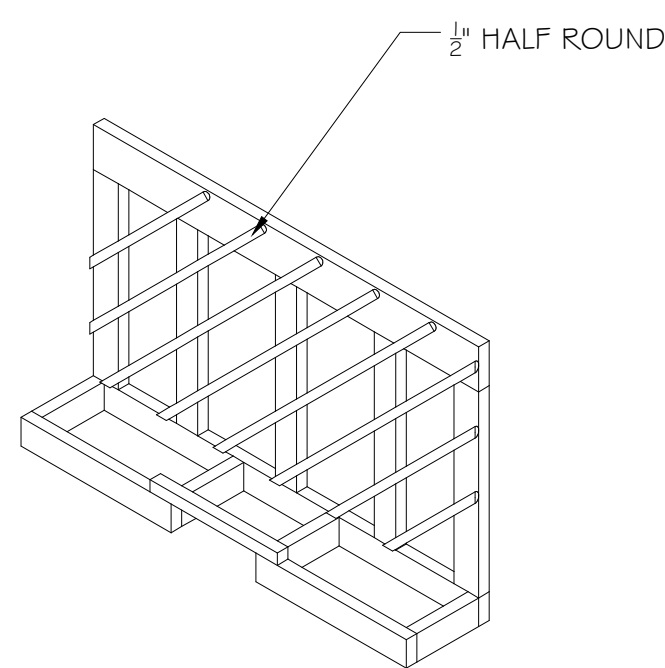
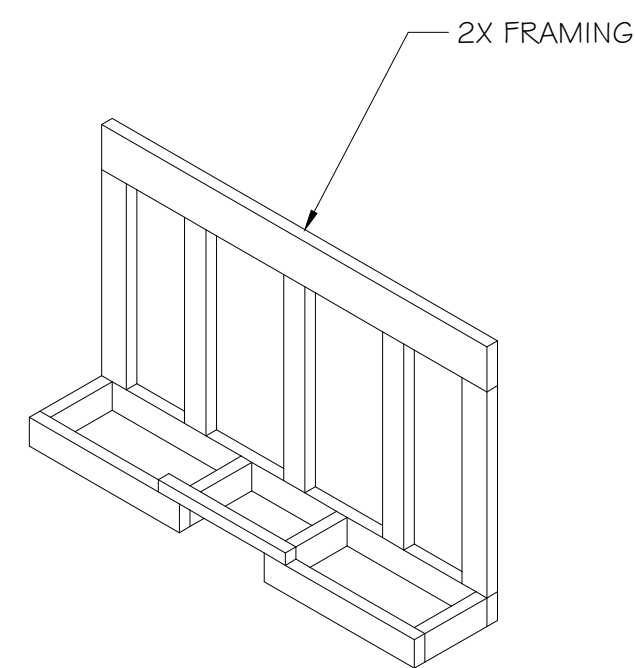

12 ISOMETRIC  
SCALE: 1" = 1'-0"

**NOTES:**  
 1) CONFIRM DESIGN AND DIMENSIONS WITH MUSIC DIRECTOR AND SOUND ENGINEER.  
 2) HARP APPLIQUE (IN 5:7) OPTIONAL AS IT WON'T BE VISIBLE IN THIS PRODUCTION.  
 3) 2X PINE, 1/2" HALF ROUND, AND LUAN ON REAR (IN 6:7) WILL BE STAINED. (NOTE GRAIN DIRECTION OF LUAN.) PLEASE USE UNPAINTED MATERIALS AND ALLOW CHARGE ACCESS BEFORE ASSEMBLY.  
 4) IF CASTERS ARE DESIRED, REDUCE CABINET HEIGHT TO MATCH CASTER HEIGHT BUT KEEP FRONT LEGS THE SAME.

THIS DRAWING REPRESENTS VISUAL CONCEPTS AND CONSTRUCTION SUGGESTIONS ONLY. IT DOES NOT REPLACE THE KNOWLEDGE AND ADVICE OF A LICENSED STRUCTURAL ENGINEER. THE DESIGNER IS UNQUALIFIED TO DETERMINE THE STRUCTURAL APPROPRIATENESS OF THIS DESIGN AND WILL NOT ASSUME RESPONSIBILITY FOR IMPROPER ENGINEERING OR USE.

BRAD STEINMETZ  
 (c) 614-749-0240  
 bradsteinmetz@gmail.com

**CATCO**  
 STUDIO TWO  
**DADDY LONG LEGS**  
 DIRECTION: S. ANDERSON  
 DESIGN: B. STEINMETZ  
 ASST DES: B. BIEDENBACH  
 TECH DIR: J. WOLFE

SCALE: 1" = 1'-0"	DRAWING: 7 OF 7
DATE: 12-23-2017	REVISION:

**FAKE PIANO**