

NOTES:
 1) INCLUDE A DETAILED NOTES SECTION.

THIS DRAWING REPRESENTS VISUAL CONCEPTS AND CONSTRUCTION SUGGESTIONS ONLY. IT DOES NOT REPLACE THE KNOWLEDGE AND ADVICE OF A LICENSED STRUCTURAL ENGINEER. THE DESIGNER IS UNQUALIFIED TO DETERMINE THE STRUCTURAL APPROPRIATENESS OF THIS DESIGN AND WILL NOT ASSUME RESPONSIBILITY FOR IMPROPER ENGINEERING OR USE.

CONTACT INFORMATION:
 EVAN BELSKY
 571-224-6699 BRAD STEINMETZ
 BELSKY.11@OSU.EDU 614-749-0240
 STEINMETZ.25@OSU.EDU



DRAKE 022
BUCKEYE TV STUDIO

DIRECTION: D. FISHER
 DESIGN: E. BELSKY
 ASST DES: B. STEINMETZ
 TECH DIR: C. MAHAN

SCALE: 3/4" = 1'-0"	PLATE: 1 OF 7
DATE: 02-05-2021	REVISION: 01

GROUND PLAN

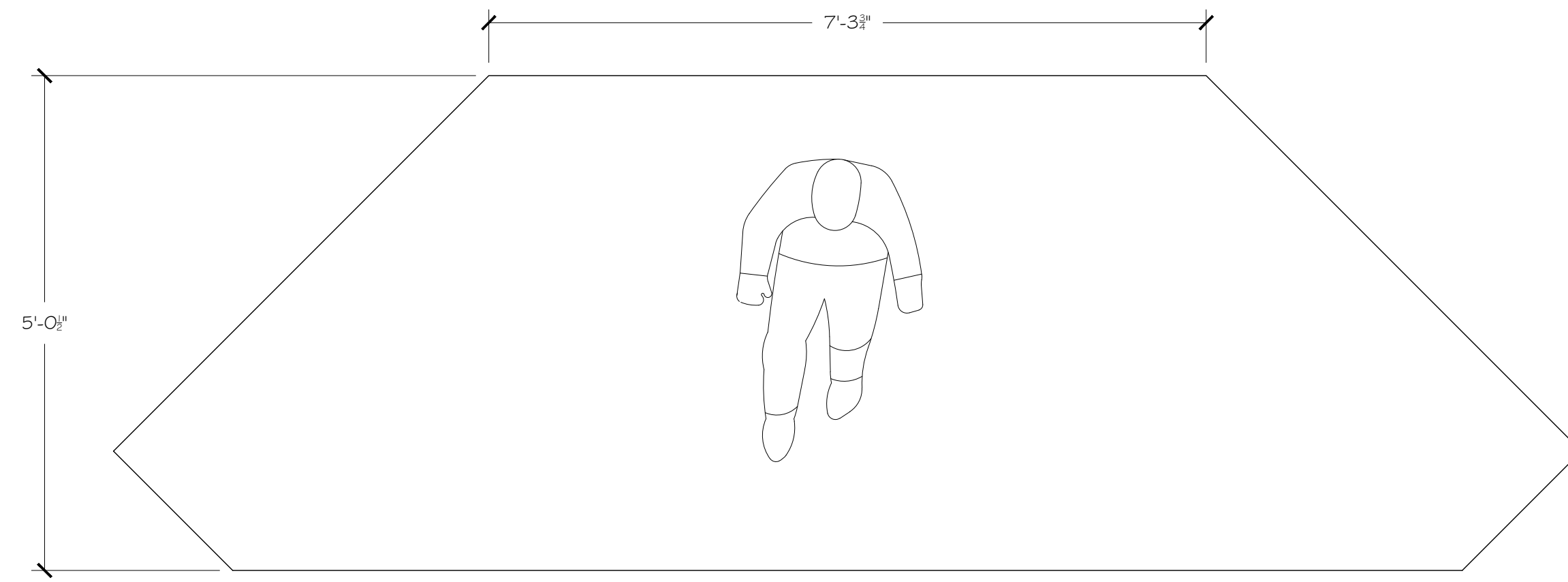

1 PLATFORM A - PLAN
2 SCALE: $\frac{3}{4}'' = 1' - 0''$

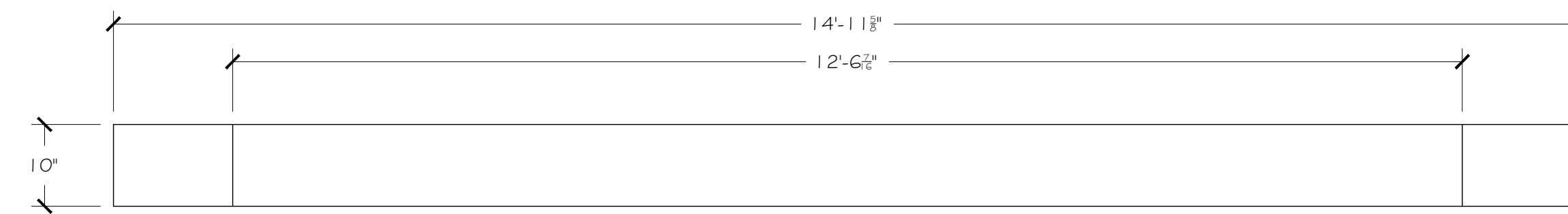

2 PLATFORM A - ELEVATION
2 SCALE: $\frac{3}{4}'' = 1' - 0''$

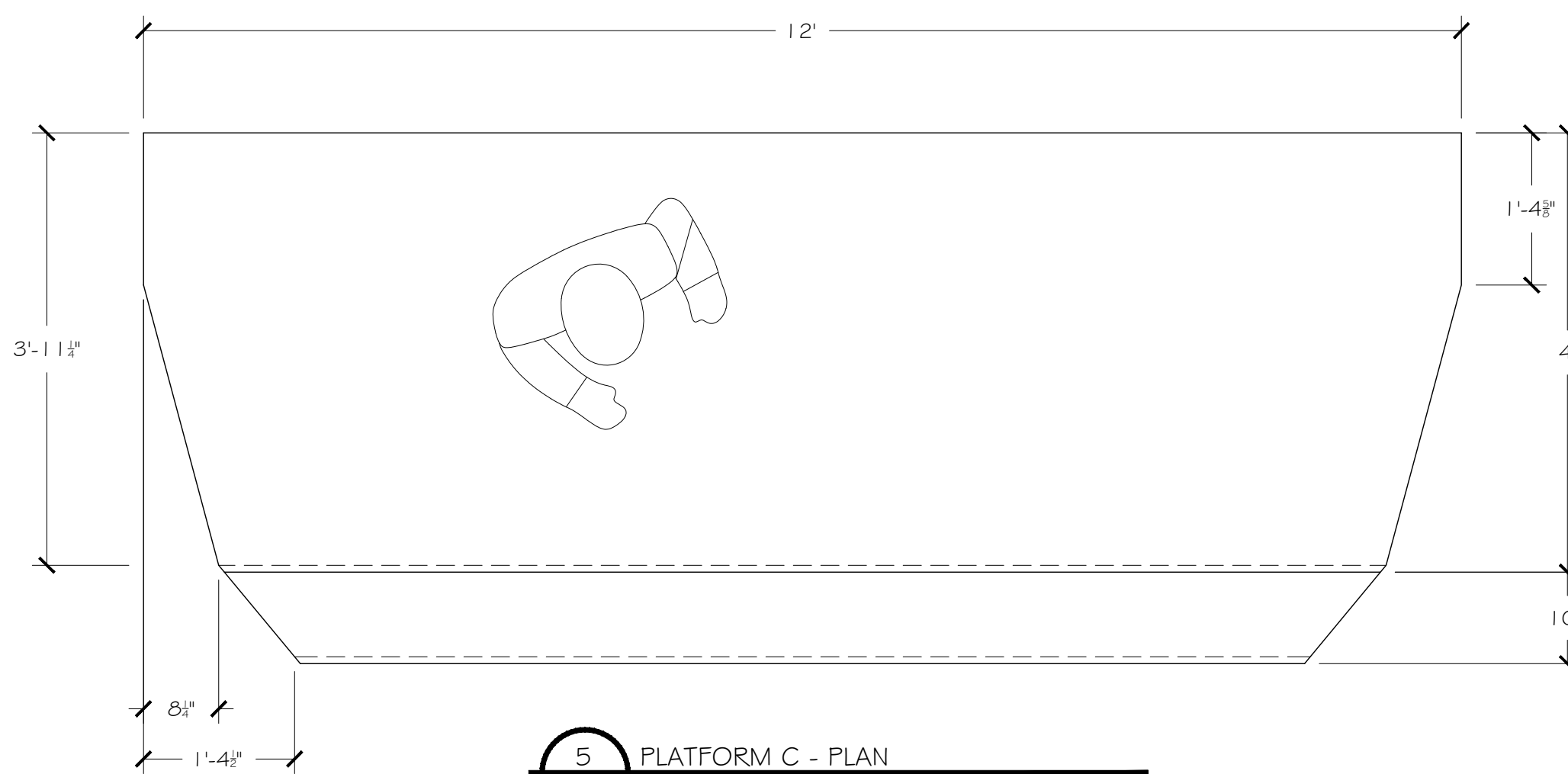

5 PLATFORM C - PLAN
2 SCALE: $\frac{3}{4}'' = 1' - 0''$



6 PLATFORM C - ELEVATION
2 SCALE: $\frac{3}{4}'' = 1' - 0''$

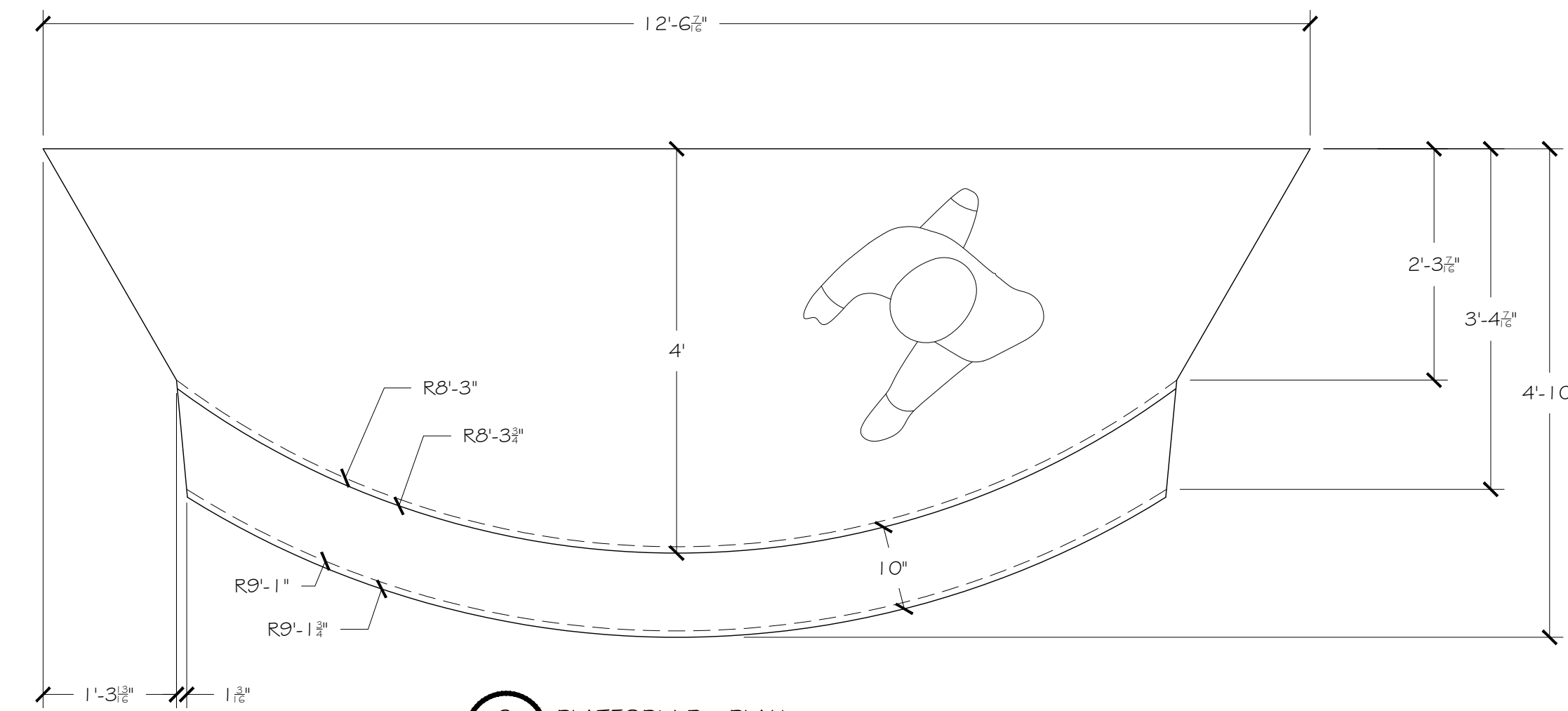

3 PLATFORM B - PLAN
2 SCALE: $\frac{3}{4}'' = 1' - 0''$

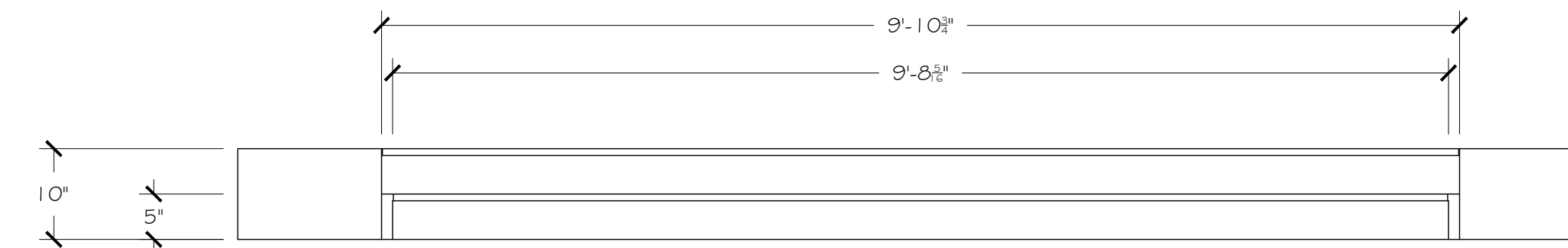

4 PLATFORM B - ELEVATION
2 SCALE: $\frac{3}{4}'' = 1' - 0''$

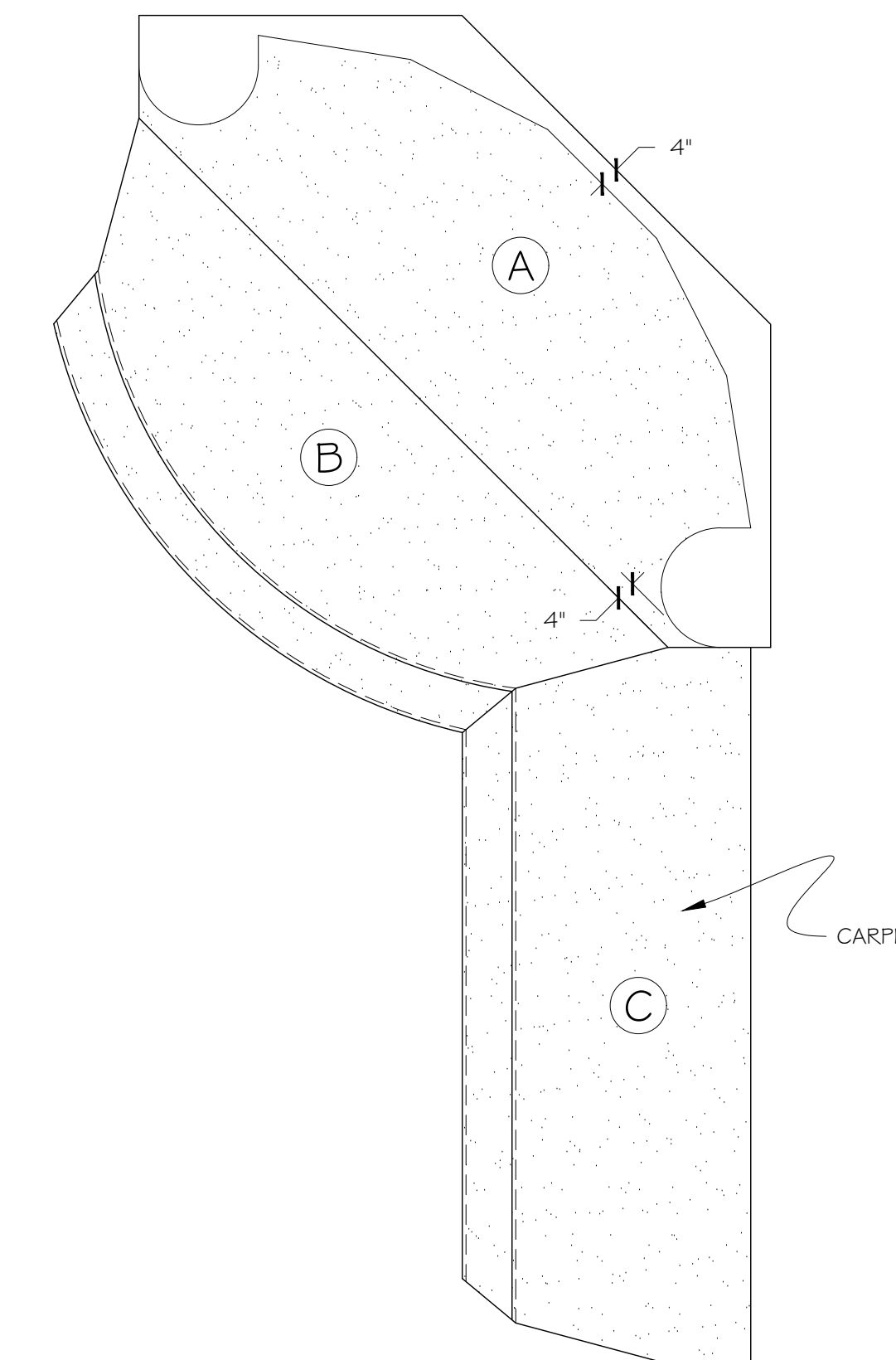

7 PLATFORM SCHEDULE
2 SCALE: $\frac{3}{8}'' = 1' - 0''$

- NOTES:
- 1) PLATFORM A IS STATIONARY AND CAN BE USED ALONE OR IN CONJUNCTION WITH OTHER PLATFORMS.
 - 2) PLATFORMS B AND C ARE MOBILE BUT MUST REMAIN STATIONARY WHEN IN PLACE.
 - 3) CENTER WALL, INCLUDING COLUMNS, CAN BE MOUNTED TO PLATFORM A.

THIS DRAWING REPRESENTS VISUAL CONCEPTS AND CONSTRUCTION SUGGESTIONS ONLY. IT DOES NOT REPLACE THE KNOWLEDGE AND ADVICE OF A LICENSED STRUCTURAL ENGINEER. THE DESIGNER IS UNQUALIFIED TO DETERMINE THE STRUCTURAL APPROPRIATENESS OF THIS DESIGN AND WILL NOT ASSUME RESPONSIBILITY FOR IMPROPER ENGINEERING OR USE.

CONTACT INFORMATION:
EVAN BELSKY
571-224-6699
BELSKY.11@OSU.EDU
BRAD STEINMETZ
614-749-0240
STEINMETZ.25@OSU.EDU

THE OHIO STATE UNIVERSITY
DRAKE 022
BUCKEYE TV STUDIO

DIRECTION: D. NAME
DESIGN: D. NAME
ASST DES: A. NAME
TECH DIR: T. NAME

SCALE: 3/4" = 1'-0"	PLATE: 2 OF 7
DATE: 02-05-2021	REVISION: 01

PLATFORMS



1 PLATFORM A - TOP AND SIDE CARPET
3 SCALE: $\frac{3}{4}'' = 1' - 0''$



2 PLATFORM C - TOP AND SIDE CARPET
3 SCALE: $\frac{3}{4}'' = 1' - 0''$

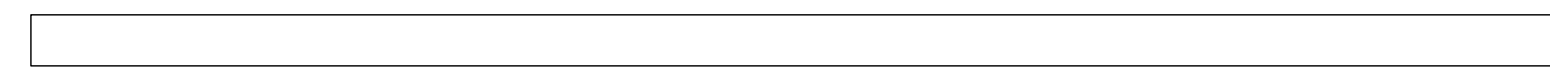

3 PLATFORM C - TOP RISER CARPET
3 SCALE: $\frac{3}{4}'' = 1' - 0''$

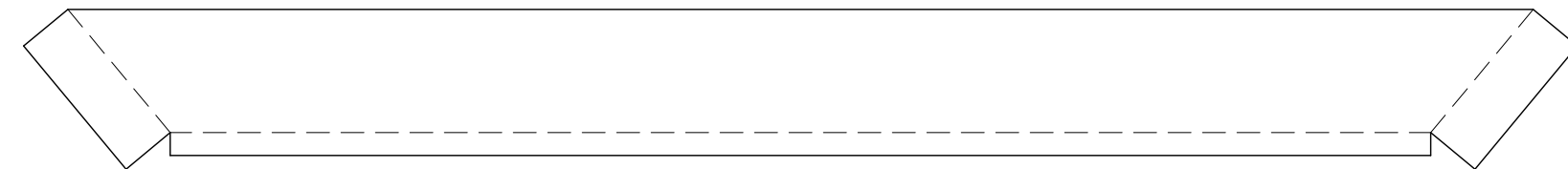

4 PLATFORM C - TREAD AND SIDE CARPET
3 SCALE: $\frac{3}{4}'' = 1' - 0''$

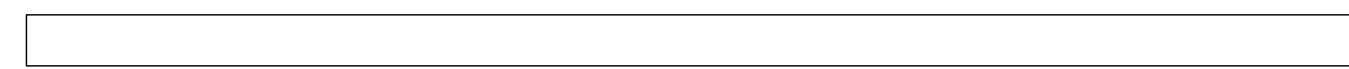

5 PLATFORM C - LOWER RISER CARPET
3 SCALE: $\frac{3}{4}'' = 1' - 0''$

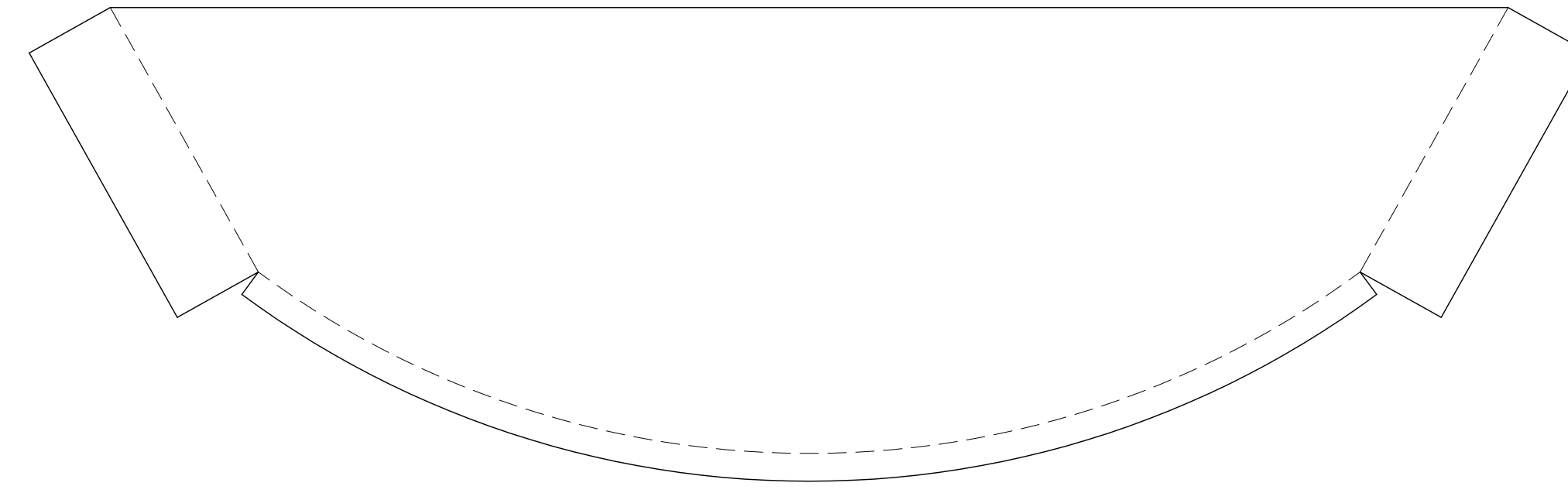

6 PLATFORM B - TOP AND SIDE CARPET
3 SCALE: $\frac{3}{4}'' = 1' - 0''$

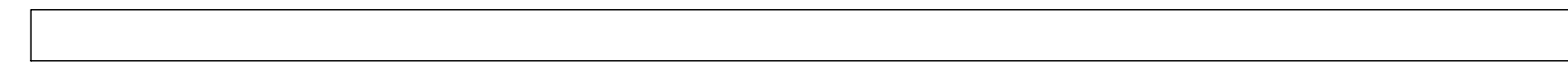

7 PLATFORM B - TOP RISER CARPET
3 SCALE: $\frac{3}{4}'' = 1' - 0''$

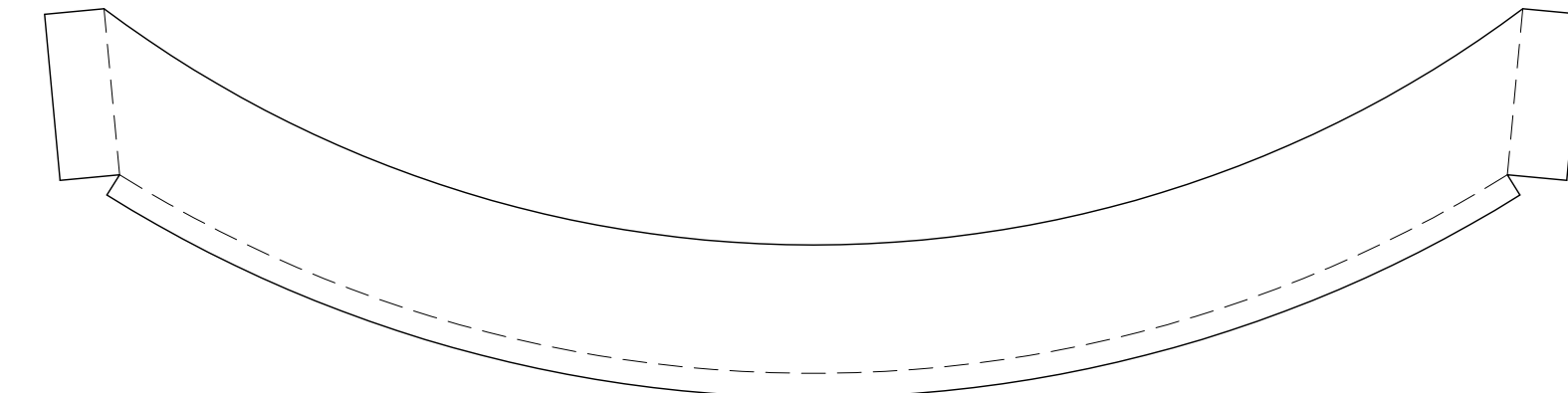

8 PLATFORM B - TREAD AND SIDE CARPET
3 SCALE: $\frac{3}{4}'' = 1' - 0''$

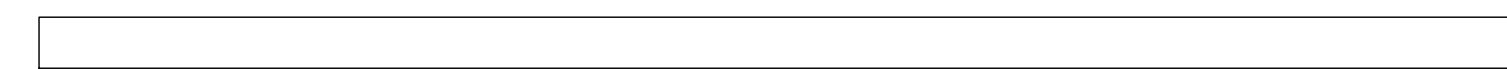

9 PLATFORM B - LOWER RISER CARPET
3 SCALE: $\frac{3}{4}'' = 1' - 0''$

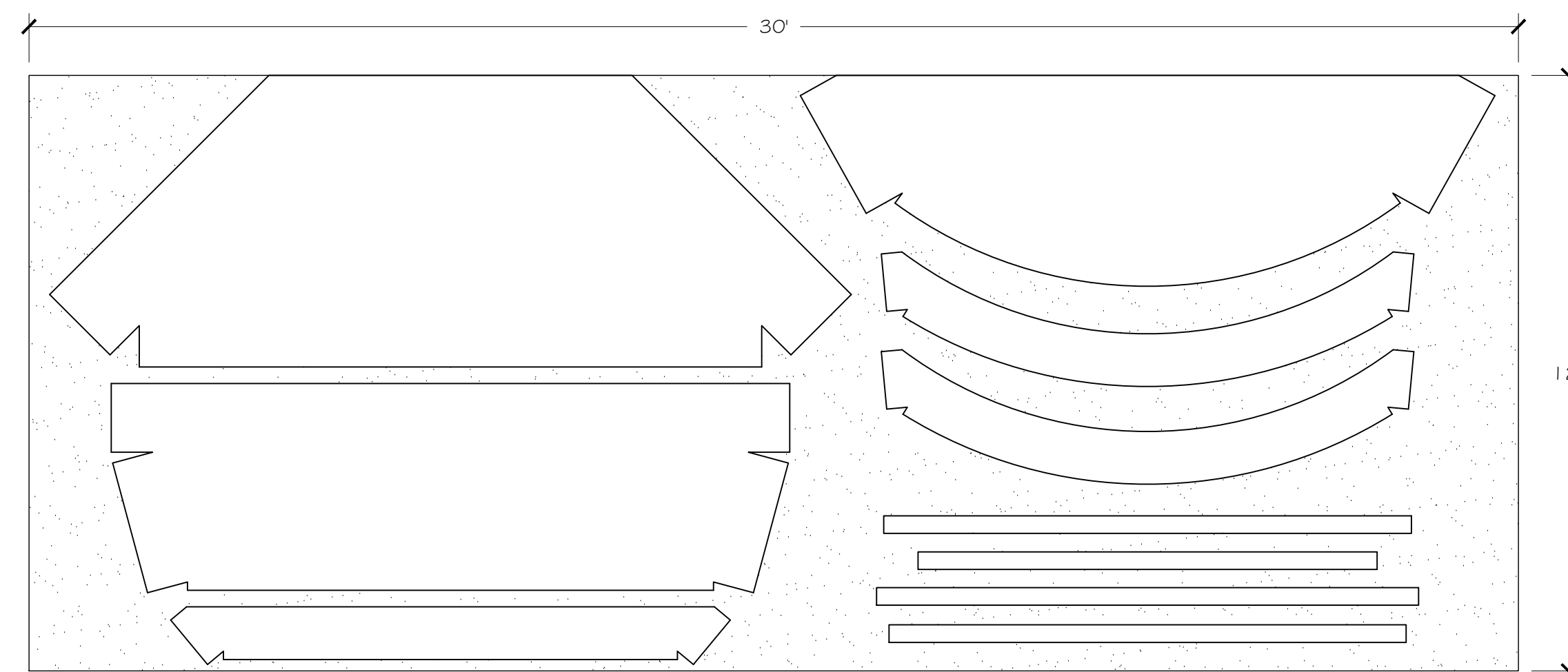

10 CARPET LAYOUT OPTION
3 SCALE: $\frac{3}{8}'' = 1' - 0''$

NOTES:

- 1) CARPET WILL LIKELY BE DARK COLORED, LOW-PILE BERBER WITHOUT A REPEATING PATTERN.
- 2) SPECIFIC CARPET SELECTION TBD.
- 3) CARPET TOPS CAN BE STAPLED AROUND BULLNOSE BEFORE RISER CARPET IS ATTACHED.
- 4) CARE SHOULD BE TAKEN TO HIDE SEAMS AND MINIMIZE RISK OF DAMAGE DUE TO WEAR AND TRAFFIC.
- 5) LAYOUT OPTION IS PROVIDED FOR STANDARD 12'-WIDE CARPET.

THIS DRAWING REPRESENTS VISUAL CONCEPTS AND CONSTRUCTION SUGGESTIONS ONLY. IT DOES NOT REPLACE THE KNOWLEDGE AND ADVICE OF A LICENSED STRUCTURAL ENGINEER. THE DESIGNER IS UNQUALIFIED TO DETERMINE THE STRUCTURAL APPROPRIATENESS OF THIS DESIGN AND WILL NOT ASSUME RESPONSIBILITY FOR IMPROPER ENGINEERING OR USE.

CONTACT INFORMATION:
EVAN BELSKY 571-224-6699
BELSKY.11@OSU.EDU
BRAD STEINMETZ 614-749-0240
STEINMETZ.25@OSU.EDU

THE OHIO STATE UNIVERSITY

DRAKE 022
BUCKEYE TV
STUDIO

DIRECTION: D. NAME
DESIGN: D. NAME
ASST DES: A. NAME
TECH DIR: T. NAME

SCALE: 3/4" = 1'-0"	PLATE: 3 OF 7
DATE: 02-05-2021	REVISION: 01

CARPET

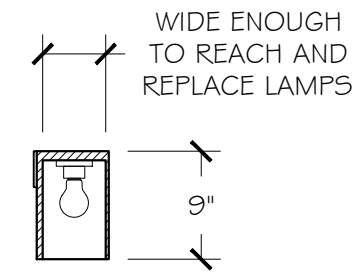

1 SR LIGHTBOX - A-A SECTION
3 SCALE: $\frac{3}{4}'' = 1' - 0''$

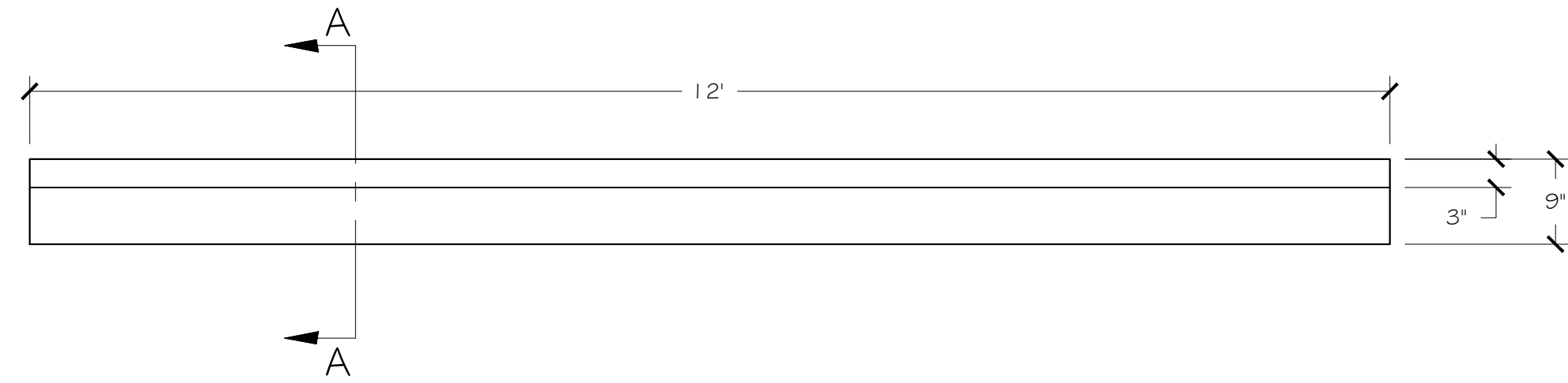

2 SR LIGHTBOX - ELEVATION
3 SCALE: $\frac{3}{4}'' = 1' - 0''$

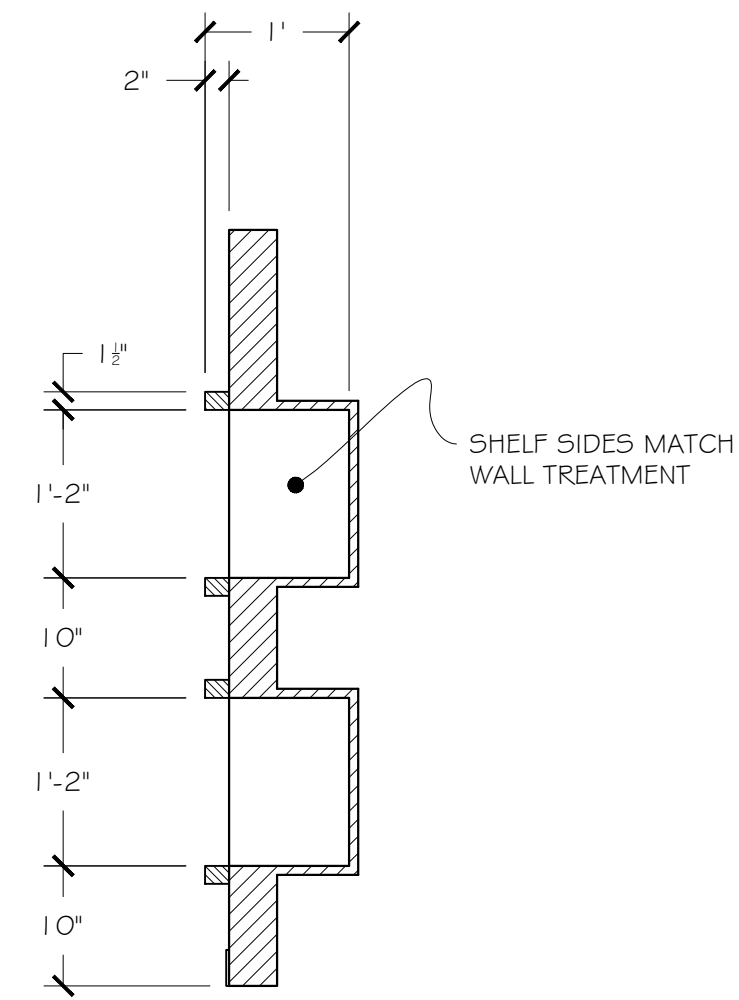

3 SR UPPER WALL - C-C SECTION
3 SCALE: $\frac{3}{4}'' = 1' - 0''$

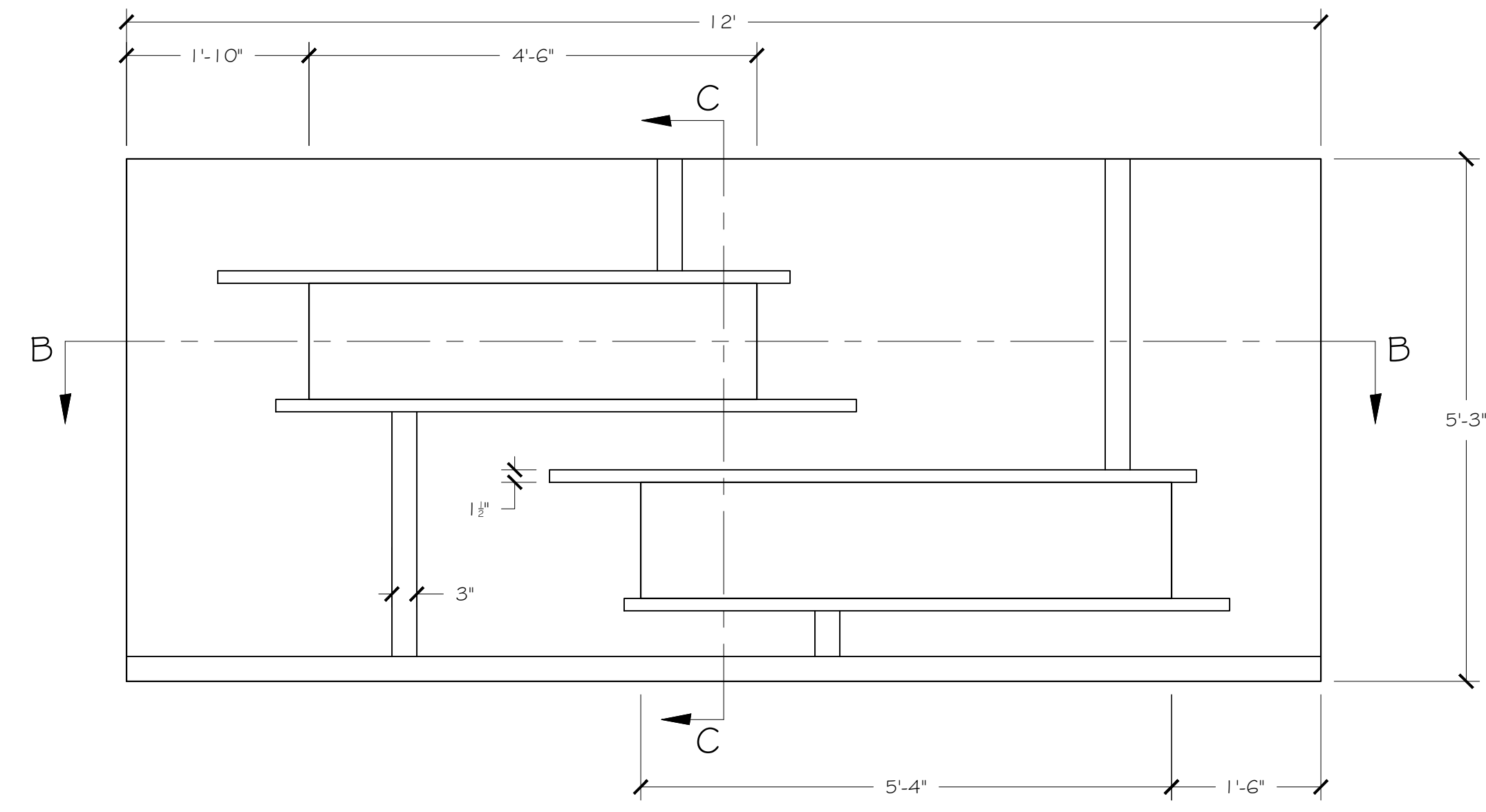

4 SR UPPER WALL - ELEVATION
3 SCALE: $\frac{3}{4}'' = 1' - 0''$

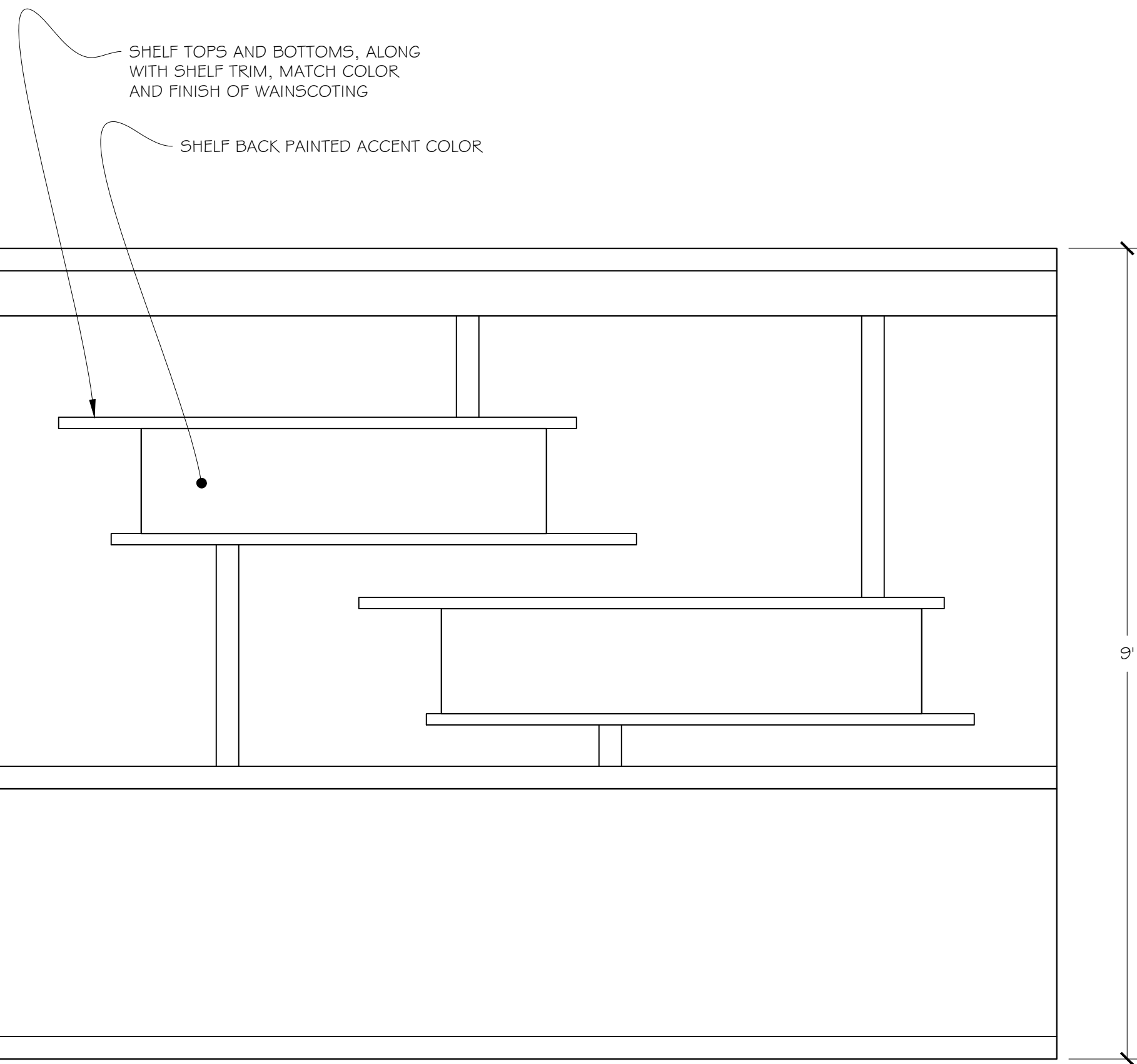

6 SR WALL - ELEVATION
3 SCALE: $\frac{3}{4}'' = 1' - 0''$

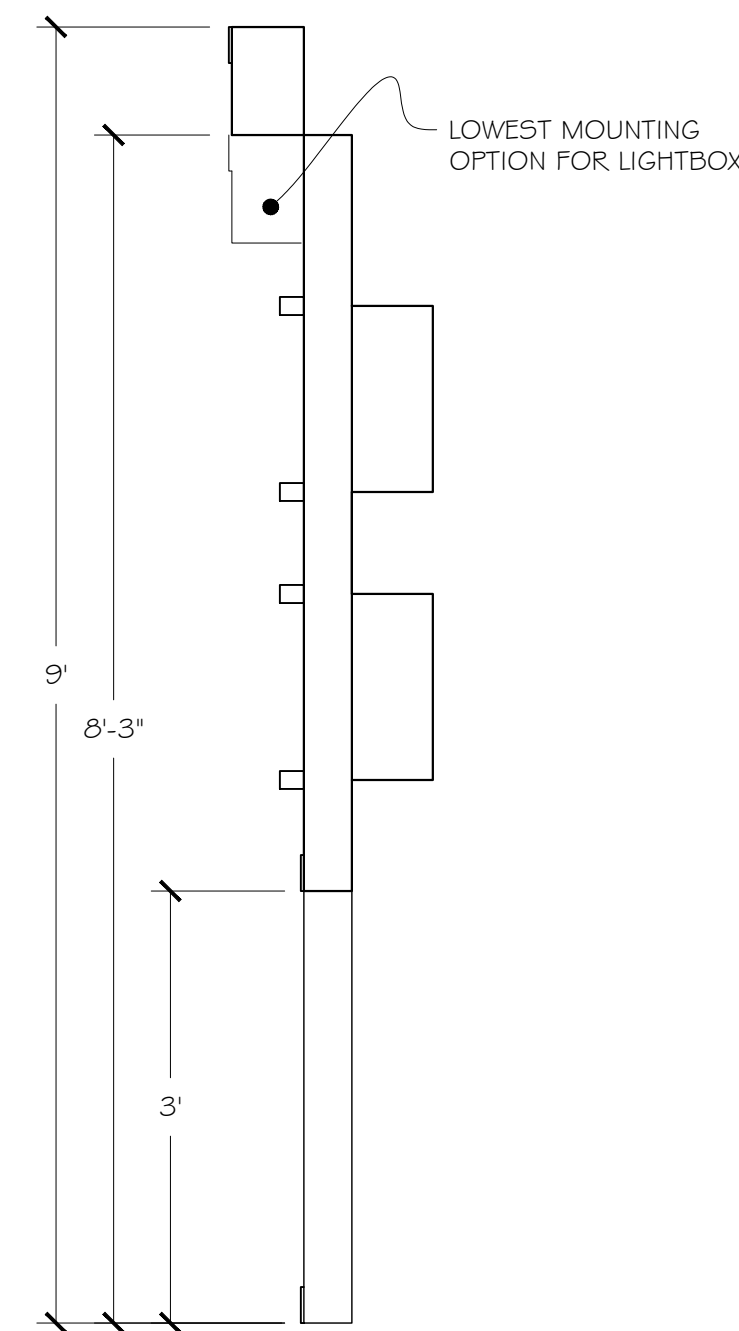

7 SR WALL - SIDE ELEVATION
3 SCALE: $\frac{3}{4}'' = 1' - 0''$

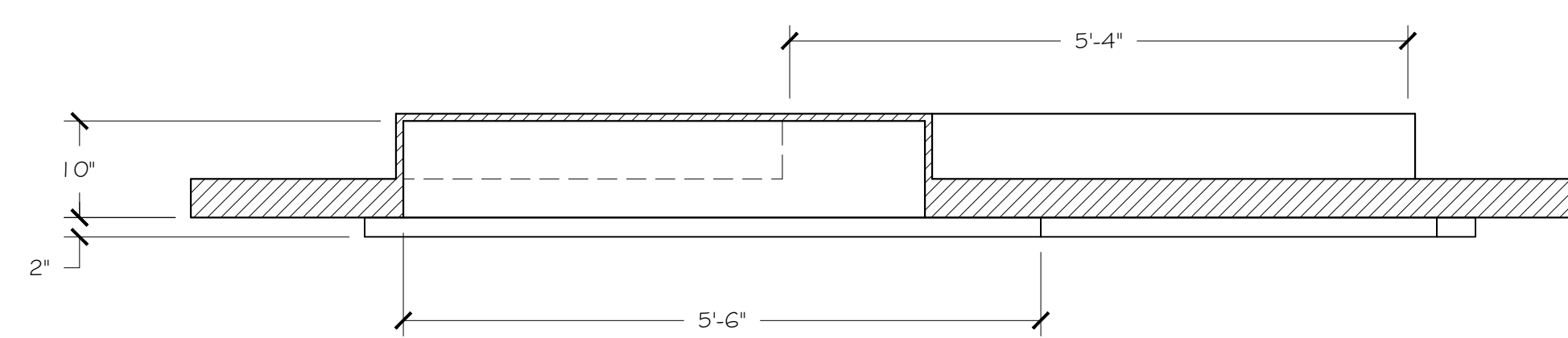

5 SR UPPER WALL - B-B SECTION
3 SCALE: $\frac{3}{4}'' = 1' - 0''$

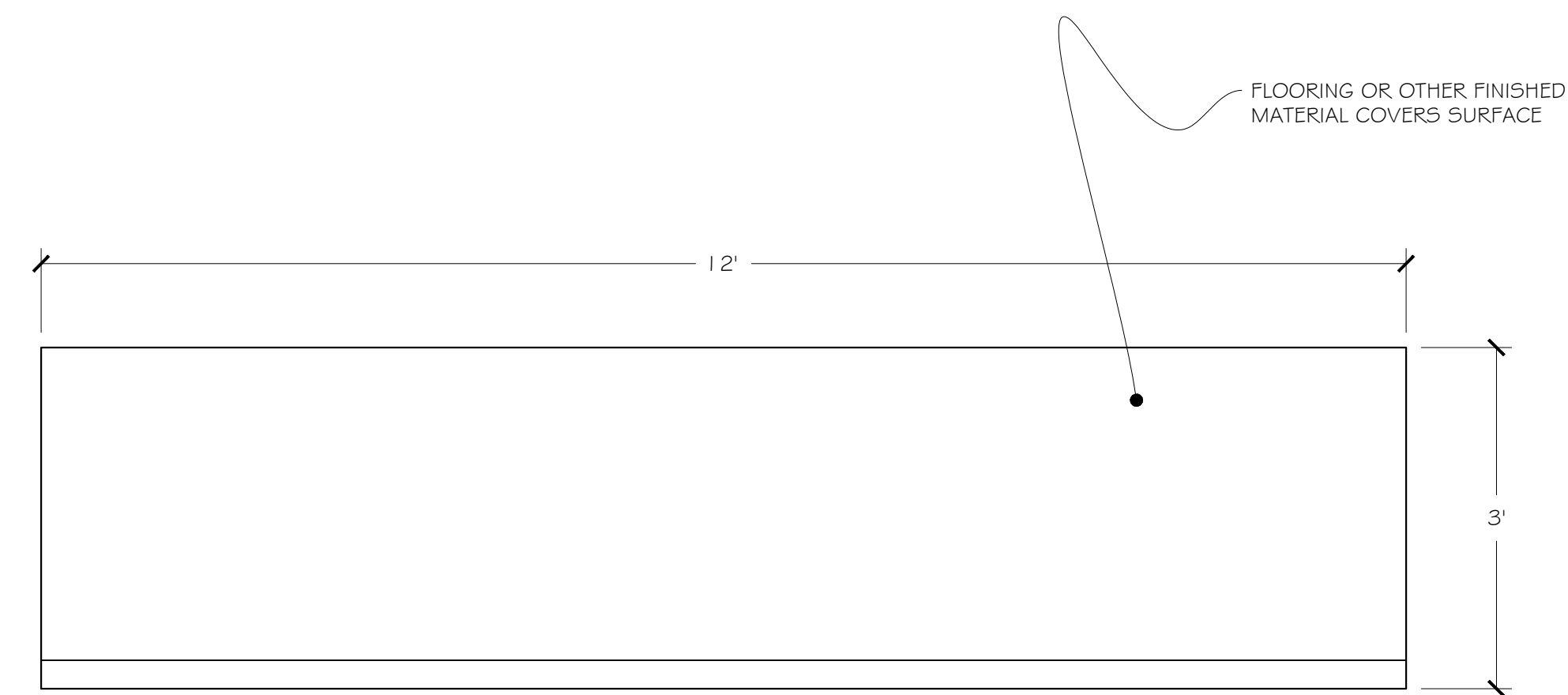

8 SR WAINSCOTING - ELEVATION
3 SCALE: $\frac{3}{4}'' = 1' - 0''$

NOTES:

- 1) LIGHTBOX MUST BE ABLE TO MOUNT TO WALL IN A VARIETY OF POSITIONS.
- 2) CONSULT WITH SDS AND DIRECTOR ON NATURE OF LIGHTING FIXTURES.
- 3) CONSULT WITH SDS AND DIRECTOR ON POSITION OF DIMMING CONTROL FOR LIGHTBOX.
- 4) SHELF SHOULD BE ABLE TO SUPPORT WEIGHT OF FULL ROW OF BOOKS.
- 5) SHELF SIDES MATCH WALL COLOR AND ARE SEAMLESS & FLUSH WITH WALL.
- 6) SHELF TOPS, BOTTOMS AND TRIM MATCH TREATMENT OF WAINSCOTING.
- 7) SHELF BACKS PAINTED ACCENT COLOR.
- 8) TRIM PIECES ARE 1/4" MATERIAL PAINTED ACCENT COLOR.
- 9) ASIDE FROM PRE-FINISHED SURFACES, ALL SURFACES SHOULD BE FILLED, SANDED BEFORE FINISH TREATMENT.
- 10) WHEN COMPLETE WALL IS MOUNTED, NO SEAMS SHOULD BE VISIBLE.
- 11) MOUNTED WALL SHOULD REMAIN RIGID AND STILL UNDER NORMAL USE.

THIS DRAWING REPRESENTS VISUAL CONCEPTS AND CONSTRUCTION SUGGESTIONS ONLY. IT DOES NOT REPLACE THE KNOWLEDGE AND ADVICE OF A LICENSED STRUCTURAL ENGINEER. THE DESIGNER IS UNQUALIFIED TO DETERMINE THE STRUCTURAL APPROPRIATENESS OF THIS DESIGN AND WILL NOT ASSUME RESPONSIBILITY FOR IMPROPER ENGINEERING OR USE.

CONTACT INFORMATION:
EVAN BELSKY 571-224-6699
BELSKY.11@OSU.EDU
BRAD STEINMETZ 614-749-0240
STEINMETZ.25@OSU.EDU

THE OHIO STATE UNIVERSITY
DRAKE 022
BUCKEYE TV STUDIO
DIRECTION: D. FISHER
DESIGN: E. BELSKY
ASST DES: B. STEINMETZ
TECH DIR: C. MAHAN

SCALE: 3/4" = 1'-0"	PLATE: 4 OF 7
DATE: 02-05-2021	REVISION: 01

SR WALL

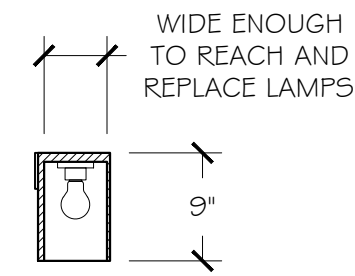

1 SL LIGHTBOX - A-A SECTION
5 SCALE: $\frac{3}{4}$ " = 1' - 0"

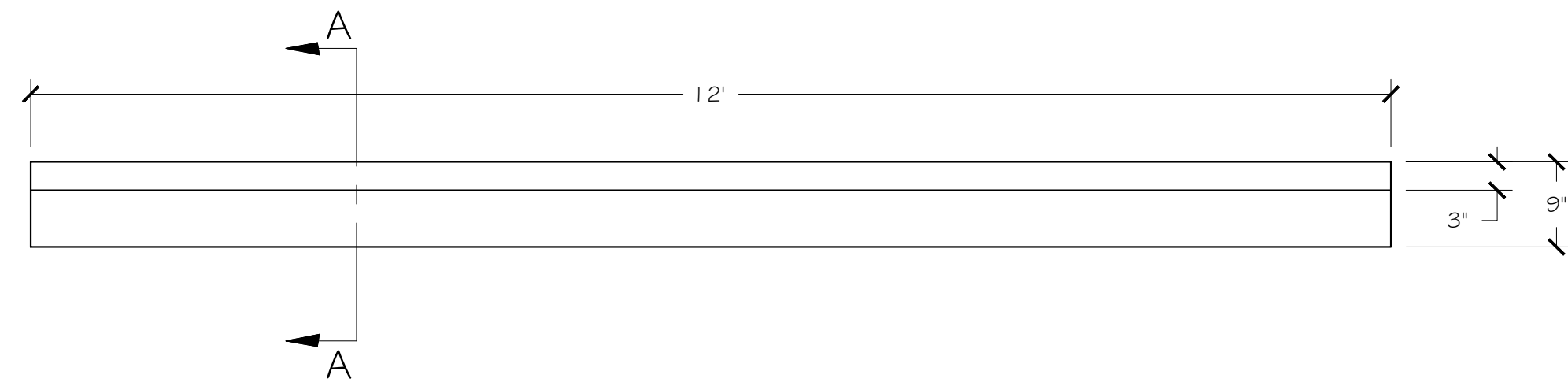

2 SL LIGHTBOX - ELEVATION
5 SCALE: $\frac{3}{4}$ " = 1' - 0"

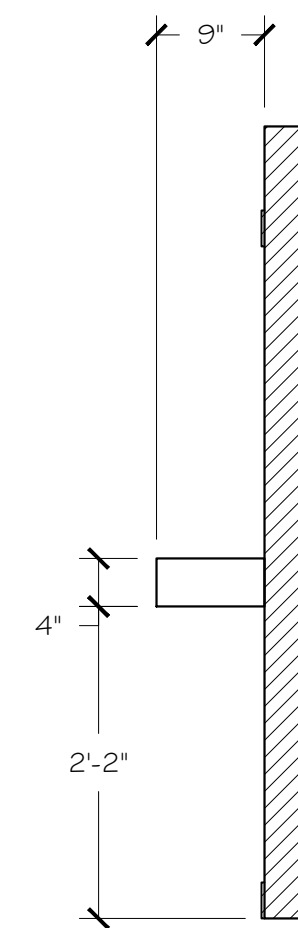

3 SL UPPER WALL - B-B SECTION
5 SCALE: $\frac{3}{4}$ " = 1' - 0"

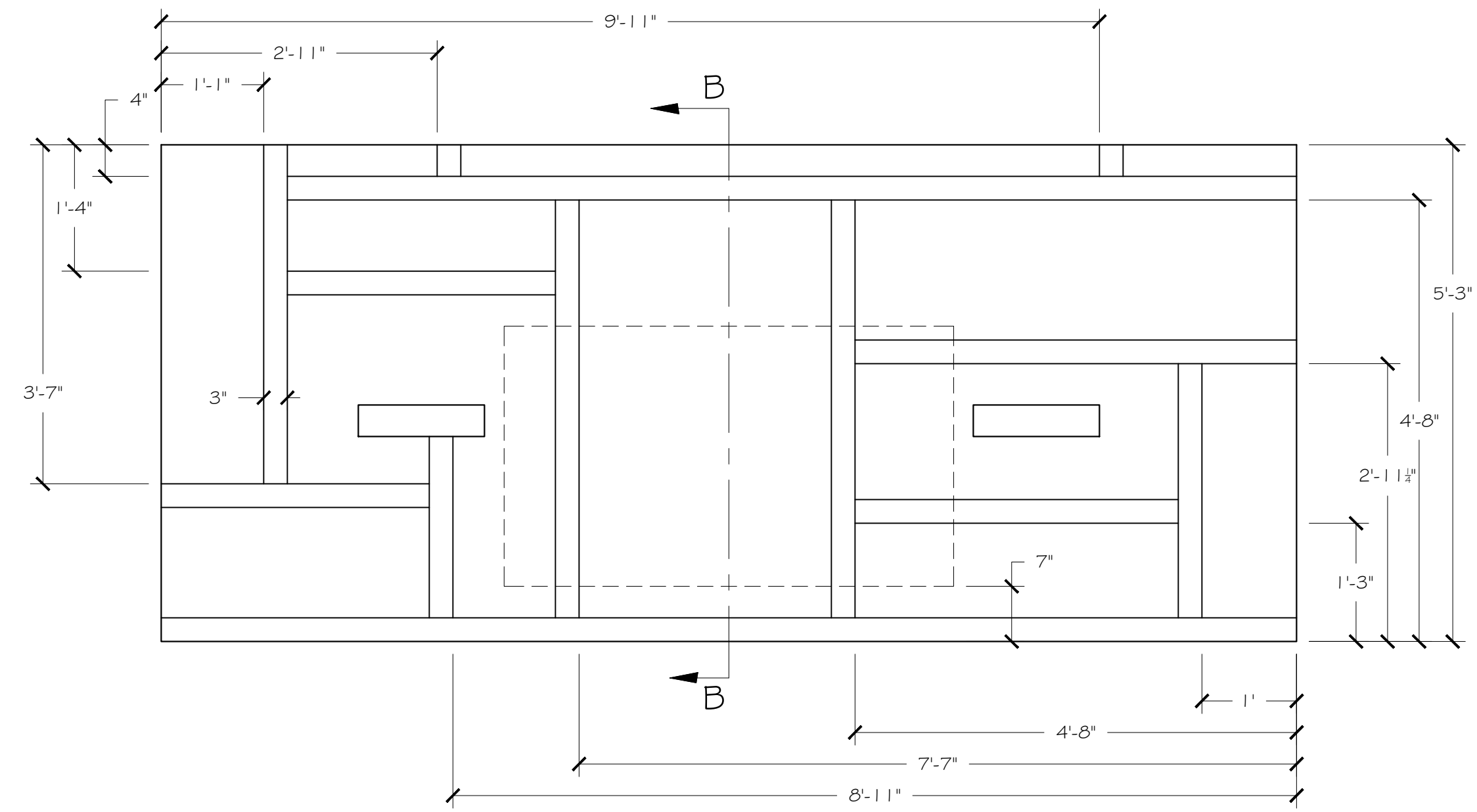

4 SL UPPER WALL - ELEVATION
5 SCALE: $\frac{3}{4}$ " = 1' - 0"

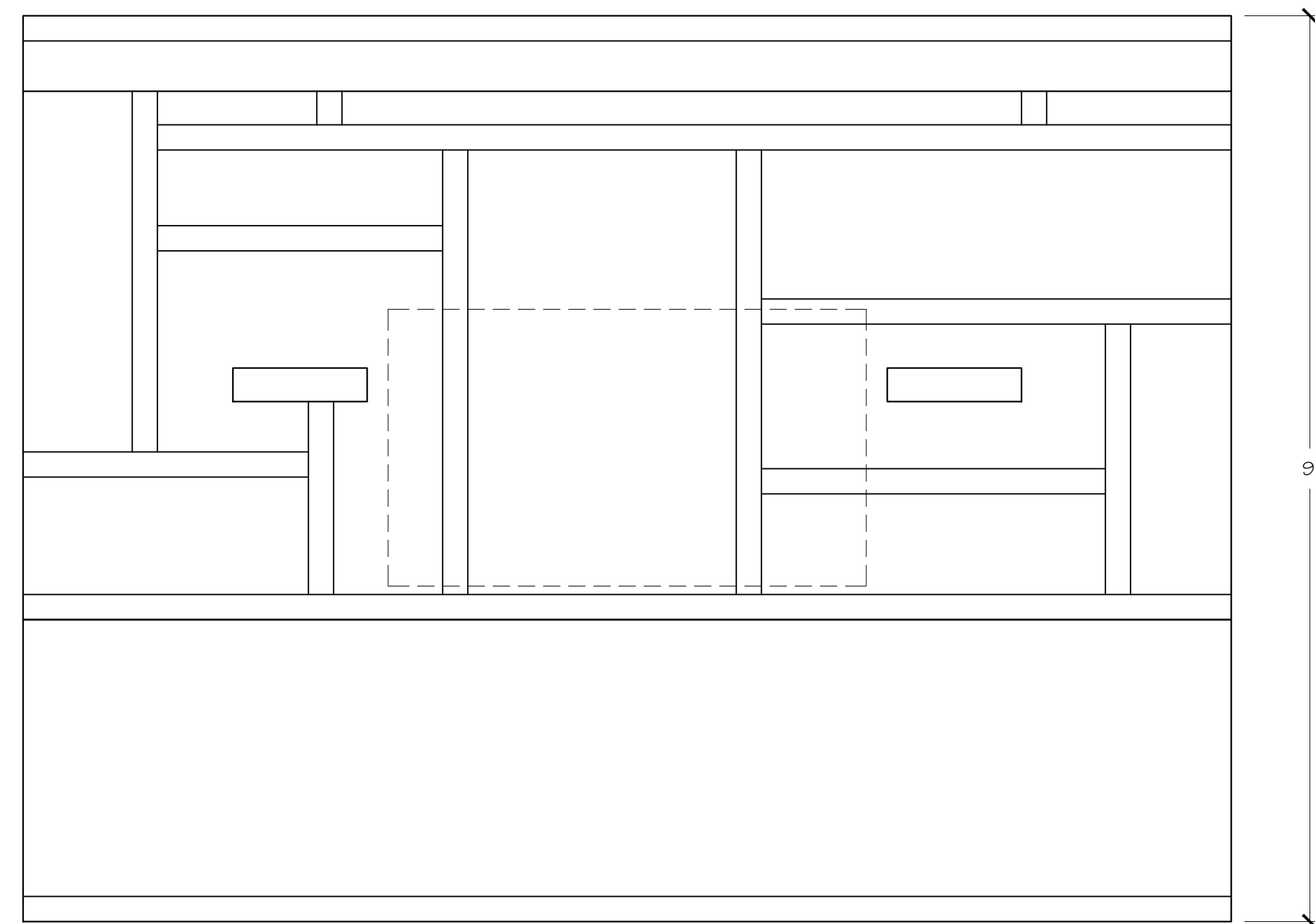

6 SL WALL - ELEVATION
5 SCALE: $\frac{3}{4}$ " = 1' - 0"

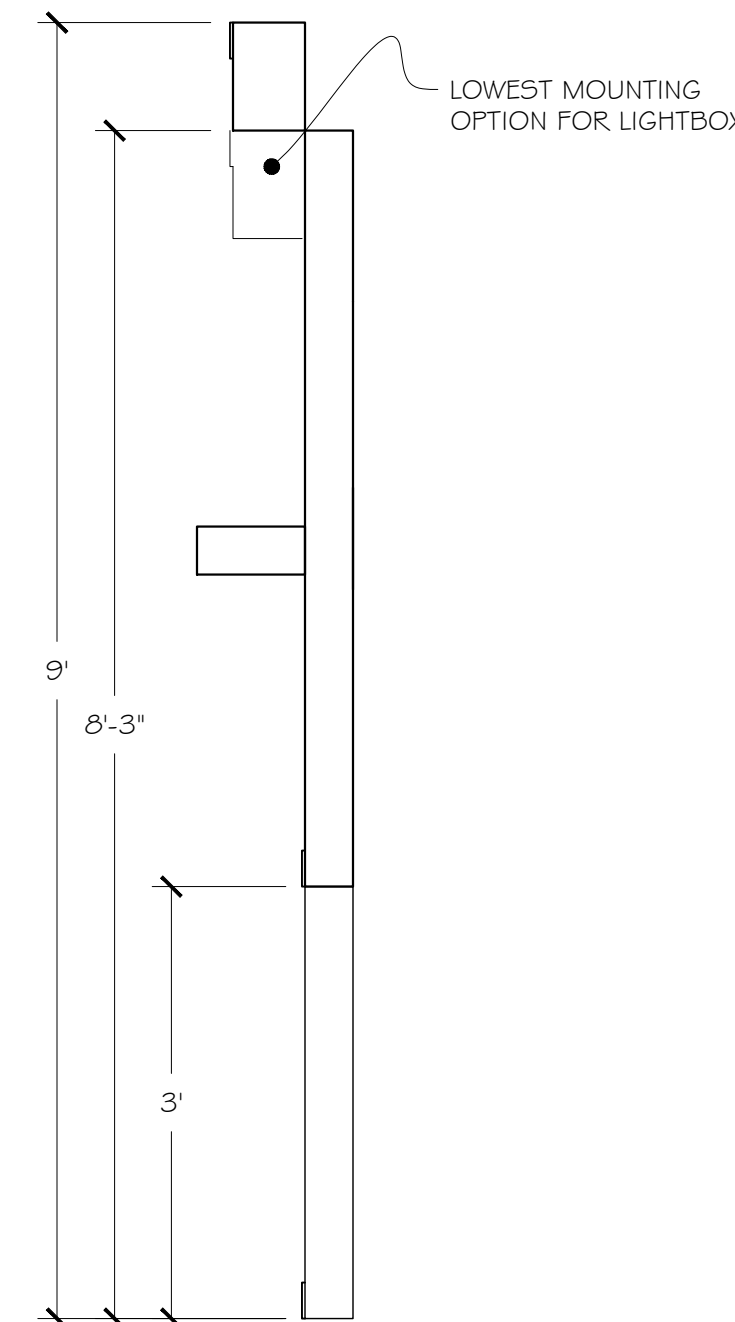

7 SL WALL - SIDE ELEVATION
5 SCALE: $\frac{3}{4}$ " = 1' - 0"

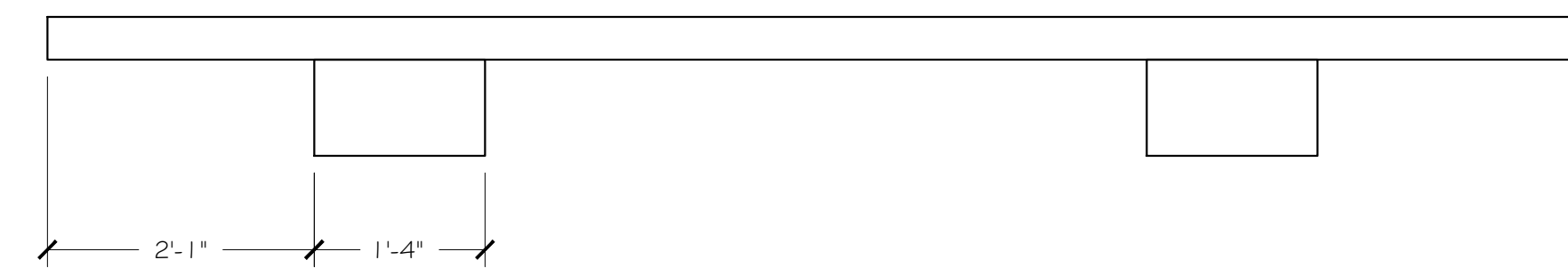

5 SL UPPER WALL - PLAN VIEW
5 SCALE: $\frac{3}{4}$ " = 1' - 0"

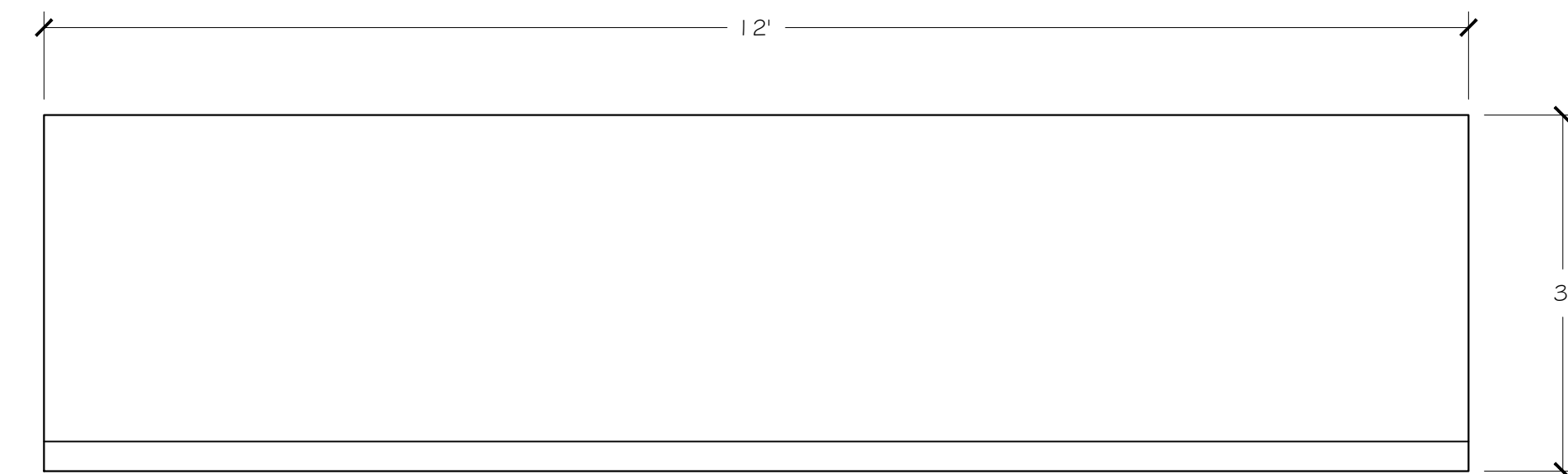

8 SL WAINSCOTING - ELEVATION
5 SCALE: $\frac{3}{4}$ " = 1' - 0"

NOTES:

- 1) LIGHTBOX MUST BE ABLE TO MOUNT TO WALL IN A VARIETY OF POSITIONS.
- 2) CONSULT WITH SDS AND DIRECTOR ON NATURE OF LIGHTING FIXTURES.
- 3) CONSULT WITH SDS AND DIRECTOR ON POSITION OF DIMMING CONTROL FOR LIGHTBOX.
- 4) SHELVES SHOULD BE ABLE TO SUPPORT WEIGHT OF FULL ROW OF BOOKS.
- 5) SHELVES MATCH TREATMENT OF WAINSCOTING.
- 6) TRIM PIECES ARE 1/4" MATERIAL PAINTED ACCENT COLOR.
- 7) ASIDE FROM PRE-FINISHED SURFACES, ALL SURFACES SHOULD BE FILLED, SANDED BEFORE FINISH TREATMENT.
- 8) WHEN COMPLETE WALL IS MOUNTED, NO SEAMS SHOULD BE VISIBLE.
- 9) MOUNTED WALL SHOULD REMAIN RIGID AND STILL UNDER NORMAL USE.

THIS DRAWING REPRESENTS VISUAL CONCEPTS AND CONSTRUCTION SUGGESTIONS ONLY. IT DOES NOT REPLACE THE KNOWLEDGE AND ADVICE OF A LICENSED STRUCTURAL ENGINEER. THE DESIGNER IS UNQUALIFIED TO DETERMINE THE STRUCTURAL APPROPRIATENESS OF THIS DESIGN AND WILL NOT ASSUME RESPONSIBILITY FOR IMPROPER ENGINEERING OR USE.

CONTACT INFORMATION:
EVAN BELSKY 571-224-6699
DELSKY.11@OSU.EDU
BRAD STEINMETZ 614-749-0240
STEINMETZ.25@OSU.EDU

THE OHIO STATE UNIVERSITY
DRAKE 022
BUCKEYE TV STUDIO
DIRECTION: D. FISHER
DESIGN: E. BELSKY
ASST DES: B. STEINMETZ
TECH DIR: C. MAHAN

SCALE: 3/4" = 1'-0"	PLATE: 5 OF 7
DATE: 02-05-2021	REVISION: 01

SL WALL

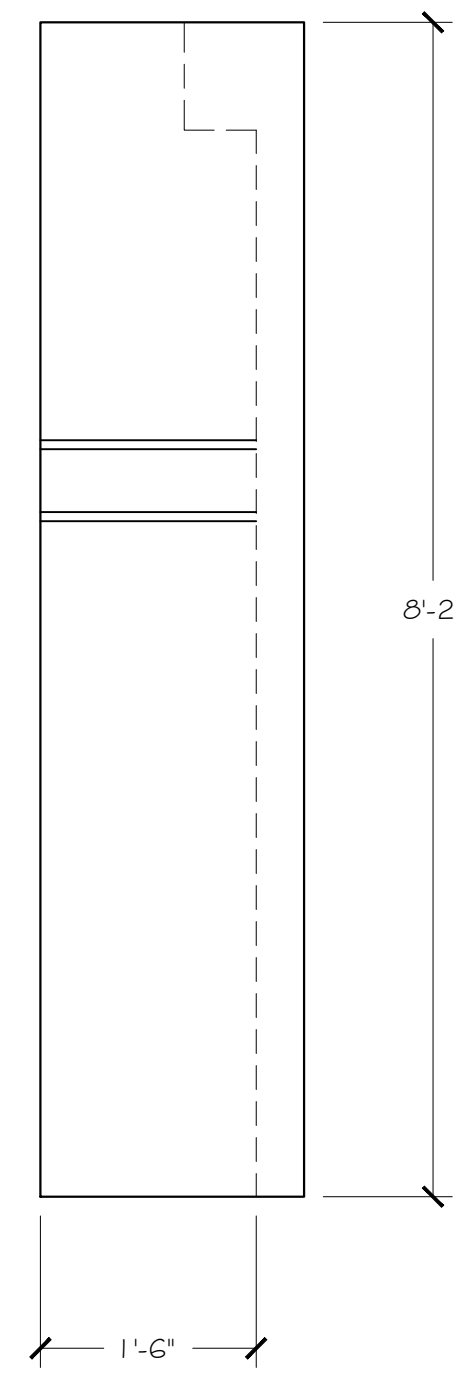

1 COLUMN - SIDE ELEVATION
6 SCALE: $\frac{3}{4}'' = 1' - 0''$

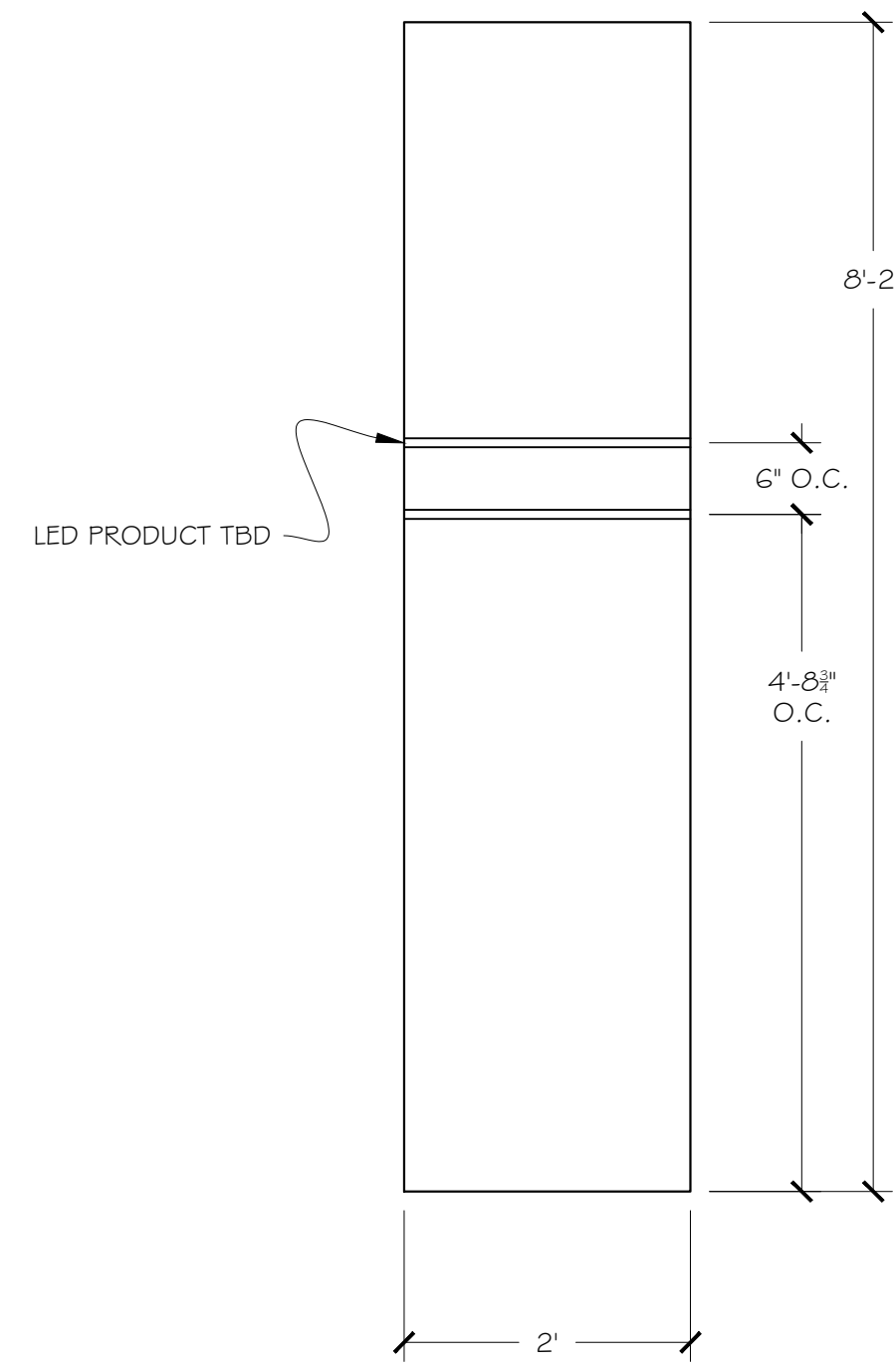

2 COLUMN - FRONT ELEVATION
6 SCALE: $\frac{3}{4}'' = 1' - 0''$

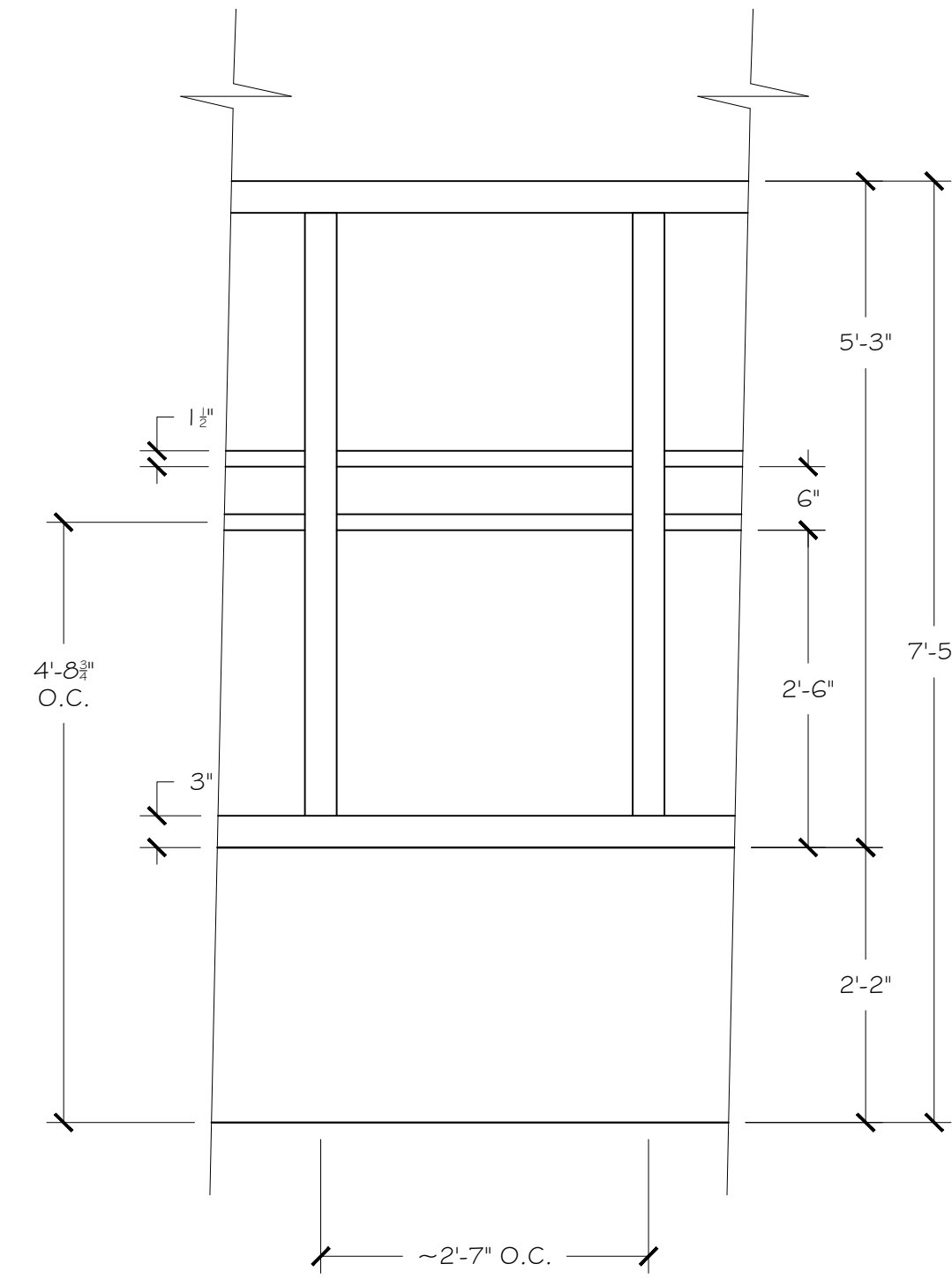

3 WINDOW UNIT - ELEVATION
6 SCALE: $\frac{3}{4}'' = 1' - 0''$

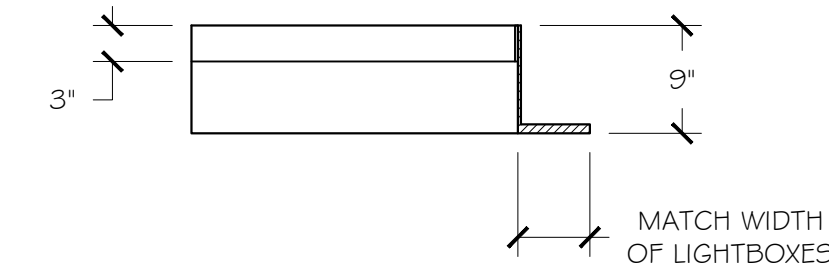
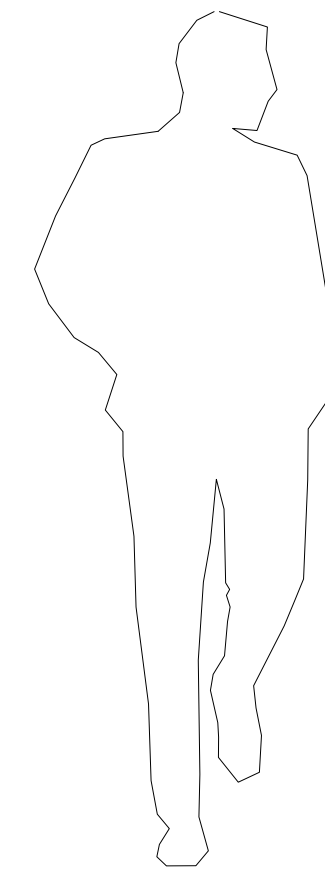

6 TRIMBOX - A-A SECTION
6 SCALE: $\frac{3}{4}'' = 1' - 0''$

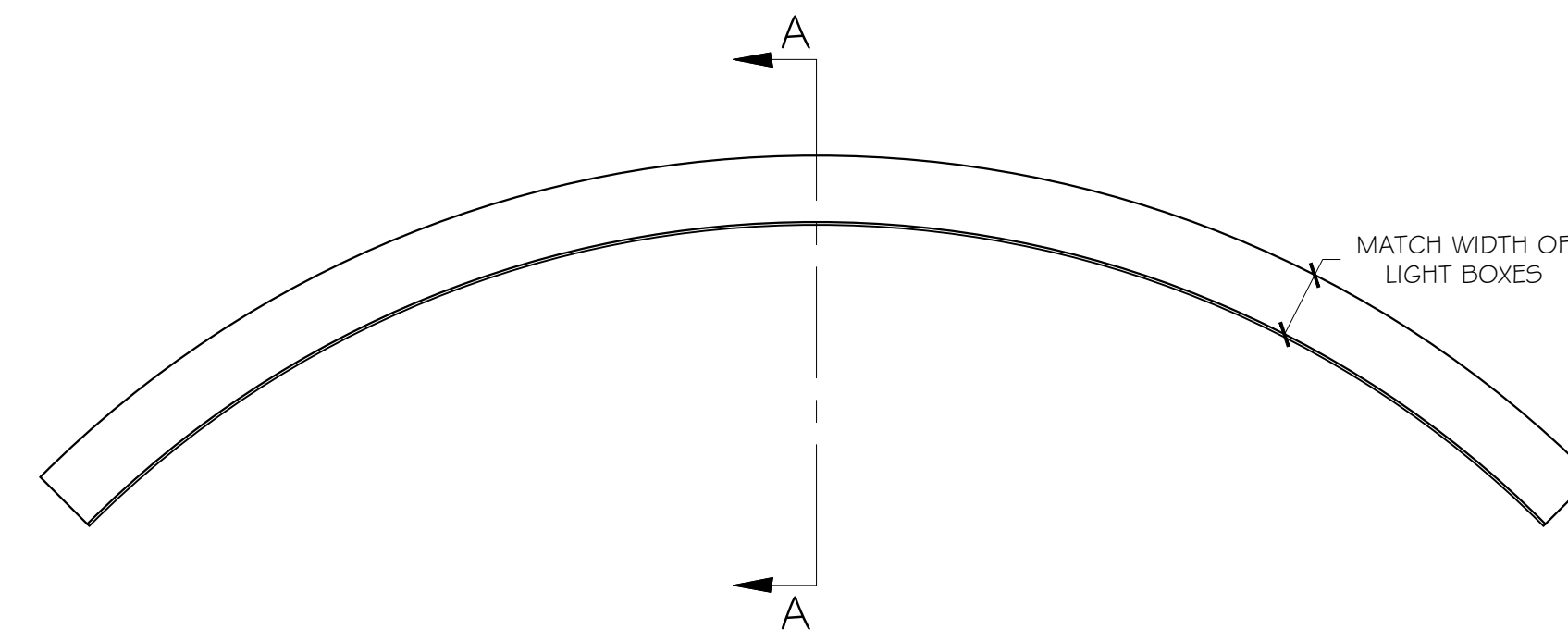

7 CENTER TRIMBOX - PLAN
6 SCALE: $\frac{3}{4}'' = 1' - 0''$

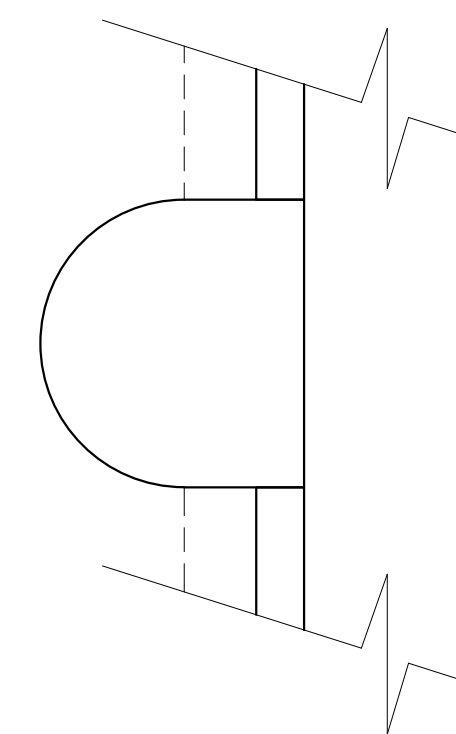

4 COLUMN IN WALL - PLAN
6 SCALE: $\frac{3}{4}'' = 1' - 0''$

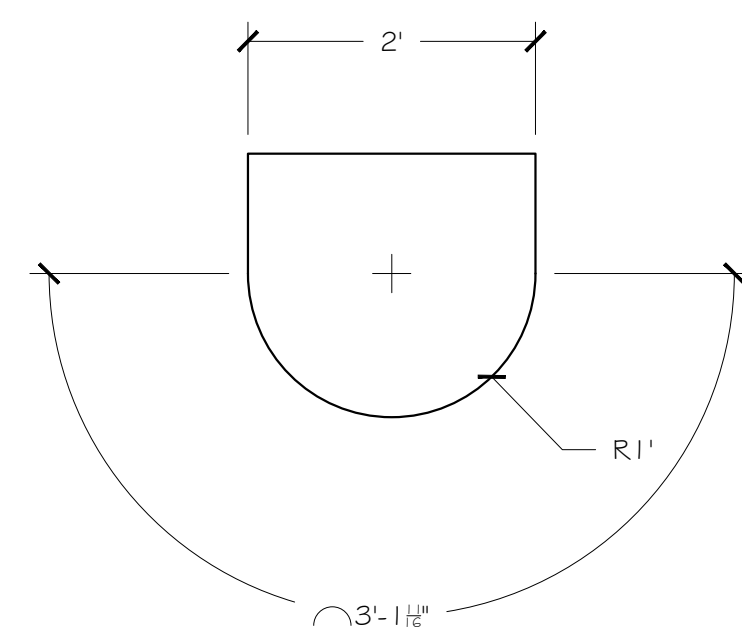

5 COLUMN - PLAN
6 SCALE: $\frac{3}{4}'' = 1' - 0''$

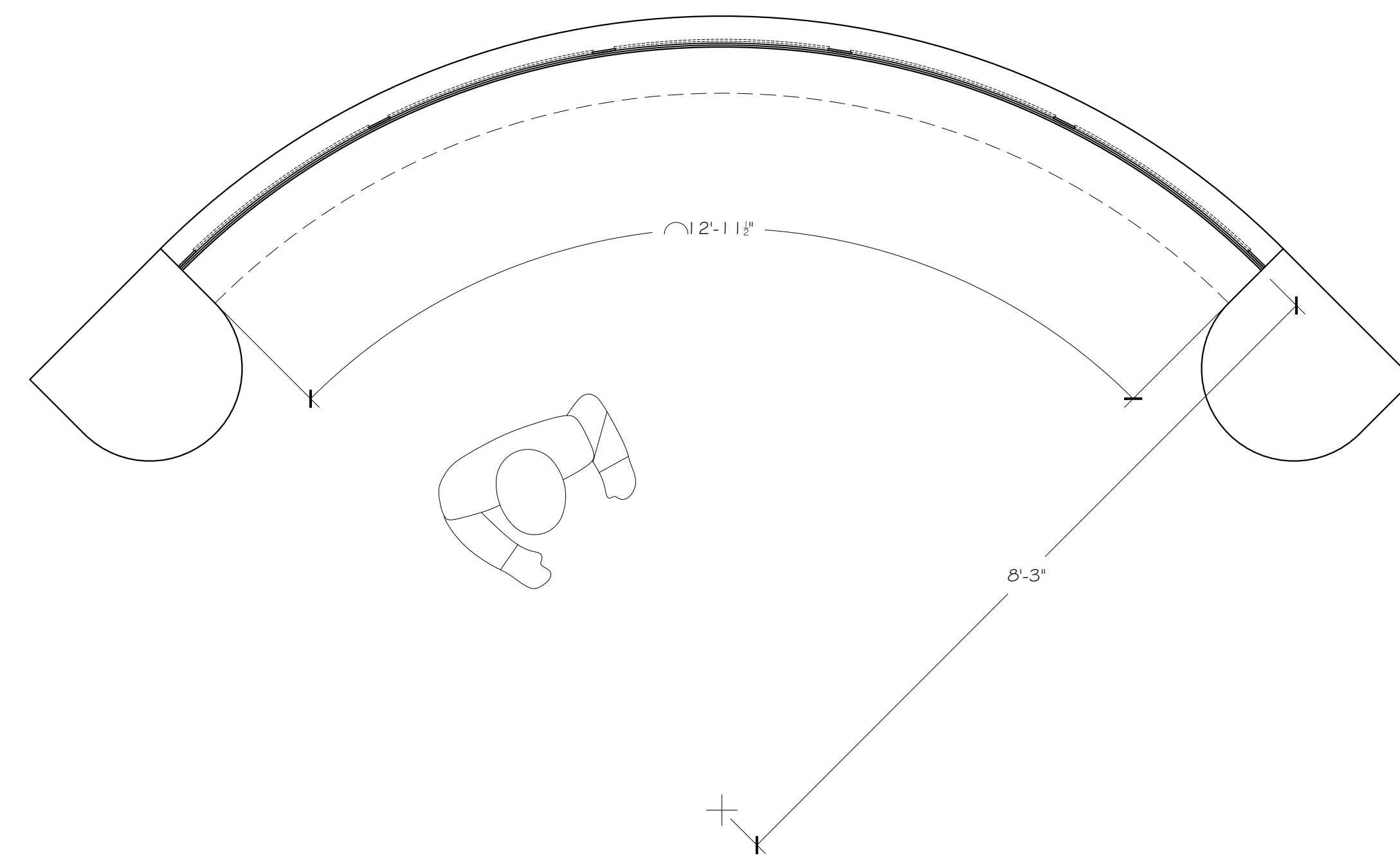

8 CENTER WALL UNIT - PLAN
6 SCALE: $\frac{3}{4}'' = 1' - 0''$

NOTES:
1)

THIS DRAWING REPRESENTS VISUAL CONCEPTS AND CONSTRUCTION SUGGESTIONS ONLY. IT DOES NOT REPLACE THE KNOWLEDGE AND ADVICE OF A LICENSED STRUCTURAL ENGINEER. THE DESIGNER IS UNQUALIFIED TO DETERMINE THE STRUCTURAL APPROPRIATENESS OF THIS DESIGN AND WILL NOT ASSUME RESPONSIBILITY FOR IMPROPER ENGINEERING OR USE.

CONTACT INFORMATION:
EVAN BELSKY
571-224-6699
BELSKY.11@OSU.EDU
BRAD STEINMETZ
614-749-0240
STEINMETZ.25@OSU.EDU

THE OHIO STATE UNIVERSITY
DRAKE 022
BUCKEYE TV STUDIO
DIRECTION: D. FISHER
DESIGN: E. BELSKY
ASST DES: B. STEINMETZ
TECH DIR: C. MAHAN

SCALE: 3/4" = 1'-0"	PLATE: 6 OF 7
DATE: 02-05-2021	REVISION: 01

CENTER WALL

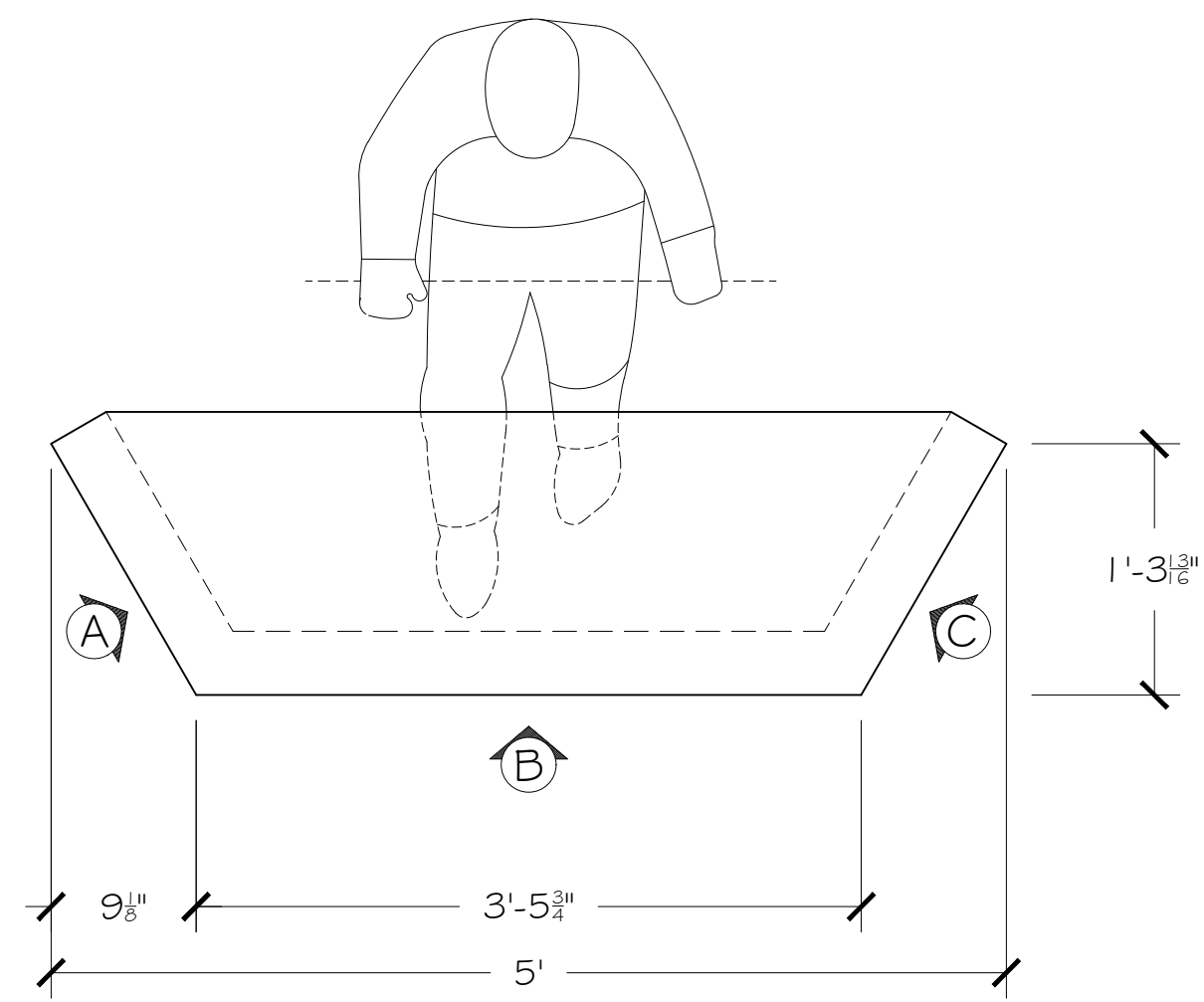

1 DESK BASE - PLAN
SCALE: 1" = 1' - 0"

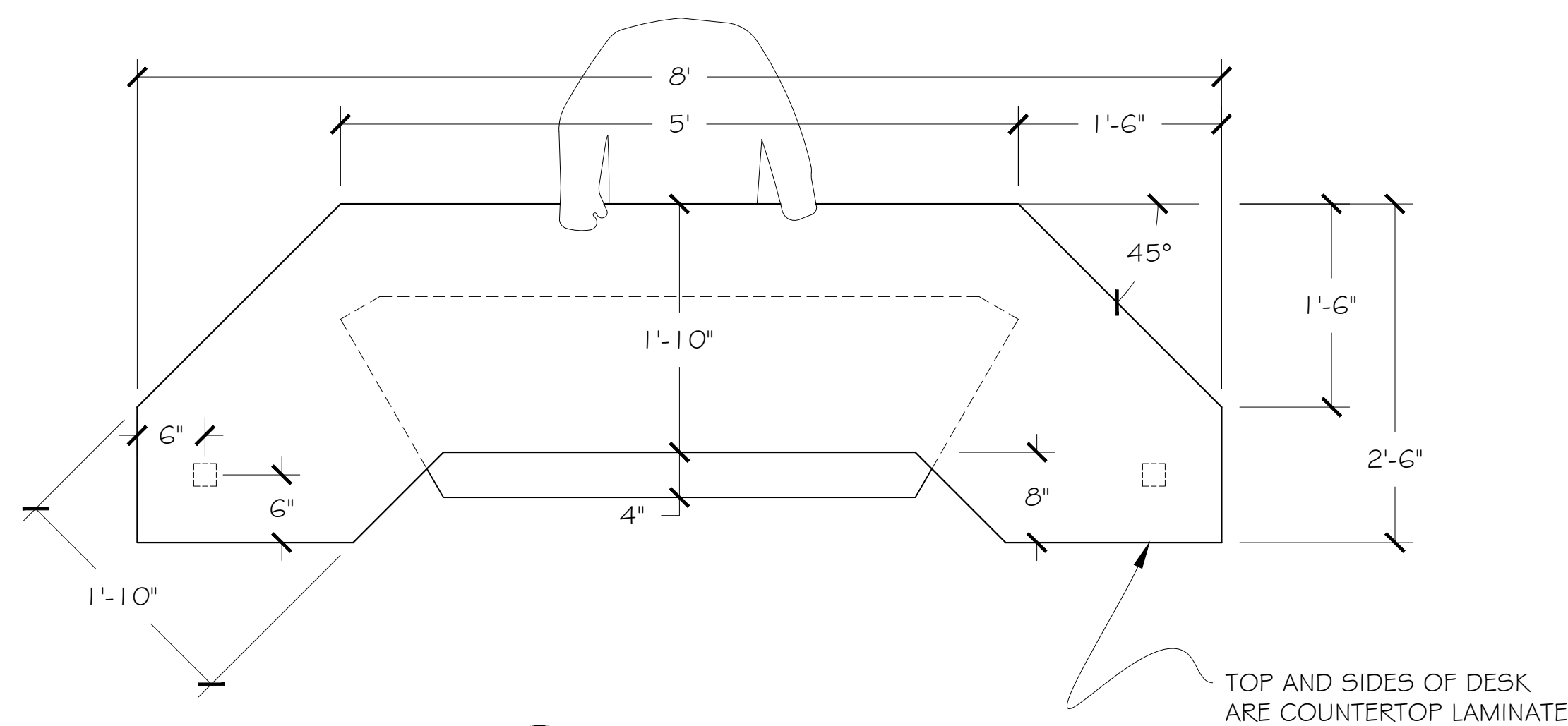

3 DESK - PLAN
SCALE: 1" = 1' - 0"

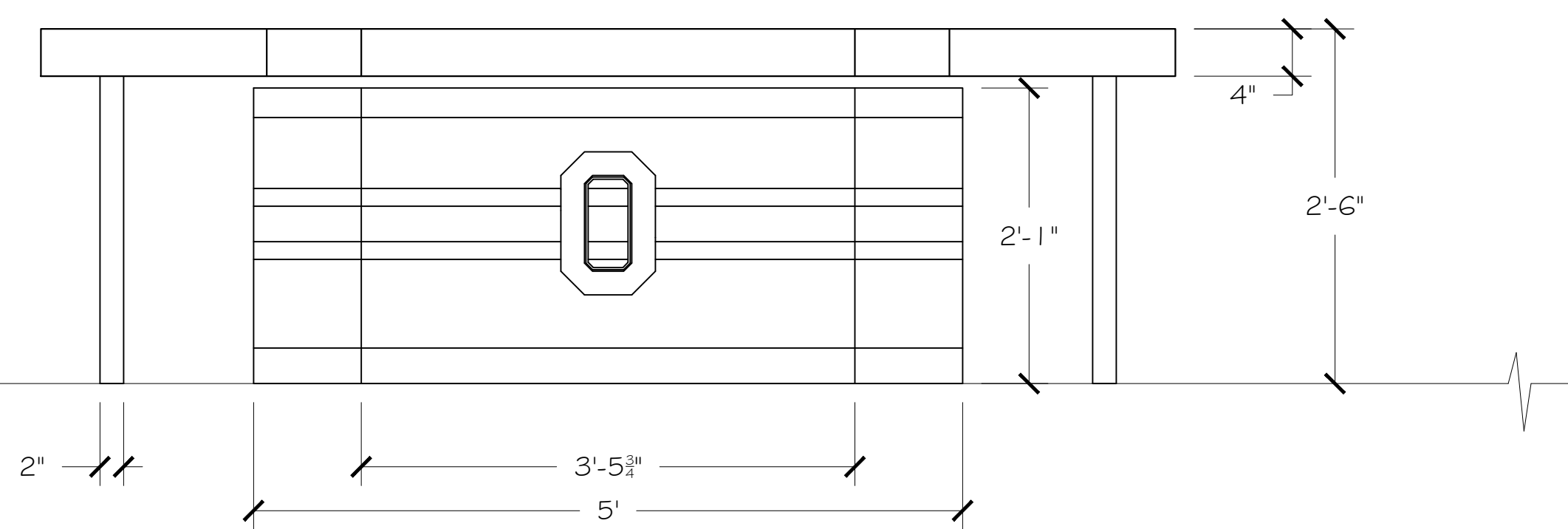
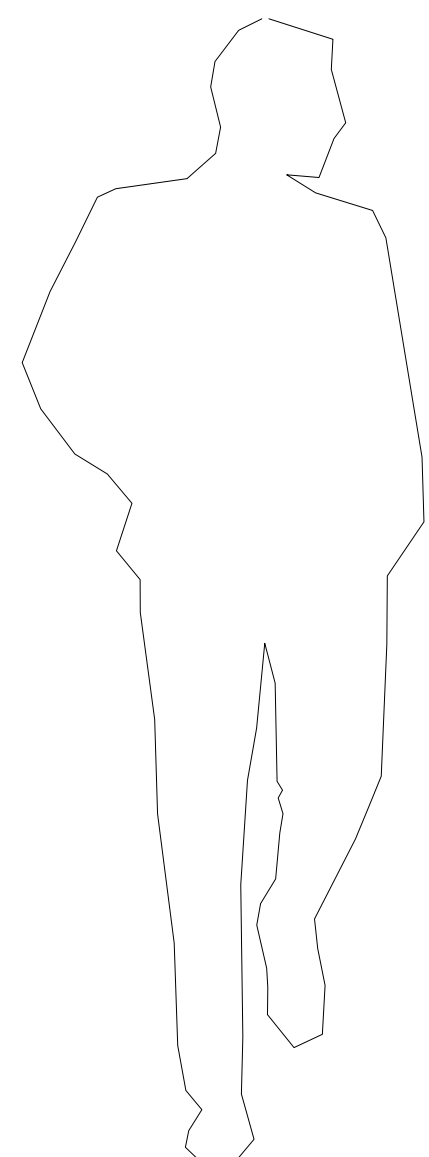

4 DESK - ELEVATION
SCALE: 1" = 1' - 0"

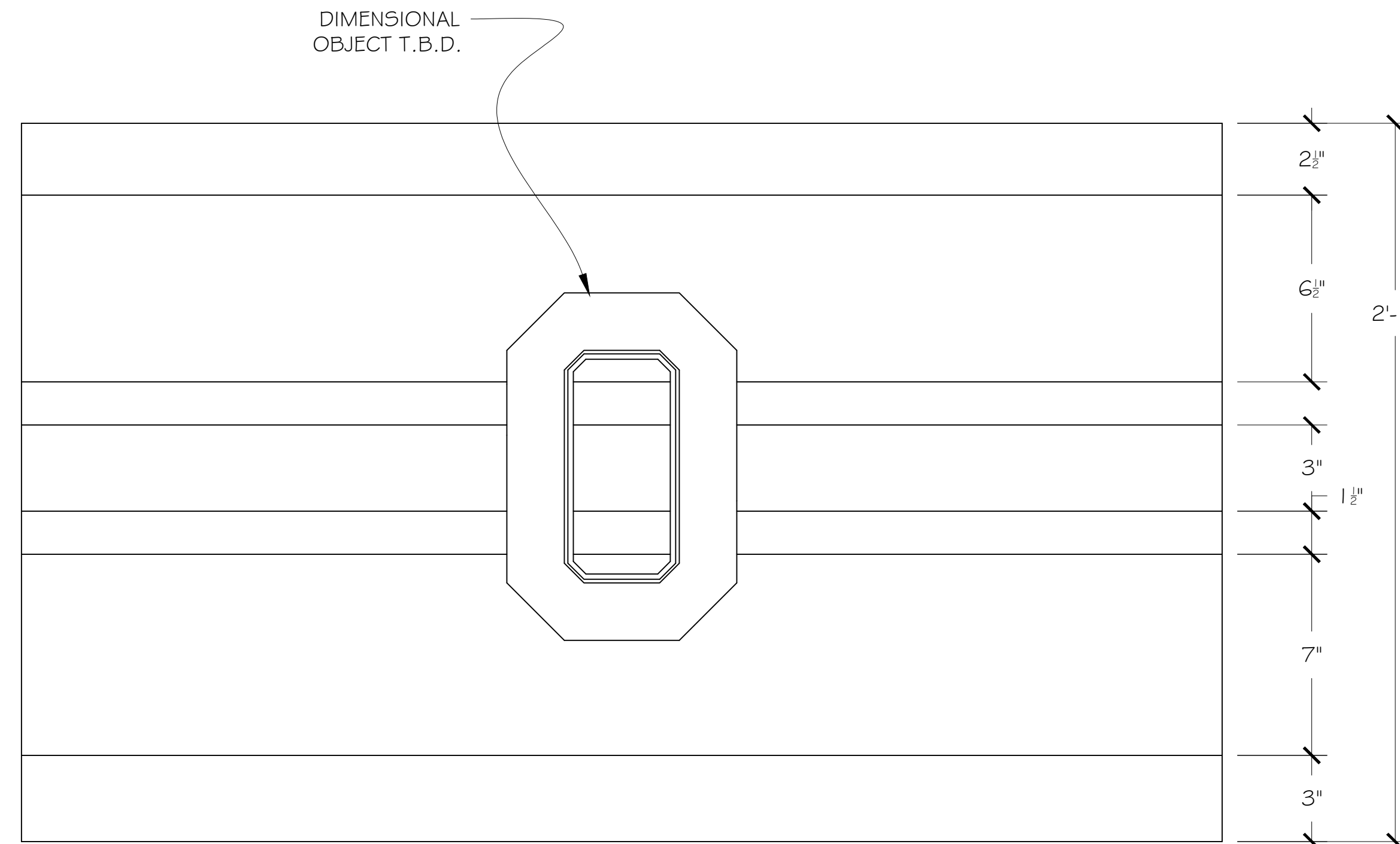

2 DESK FACE B - ELEVATION
SCALE: 3" = 1' - 0"

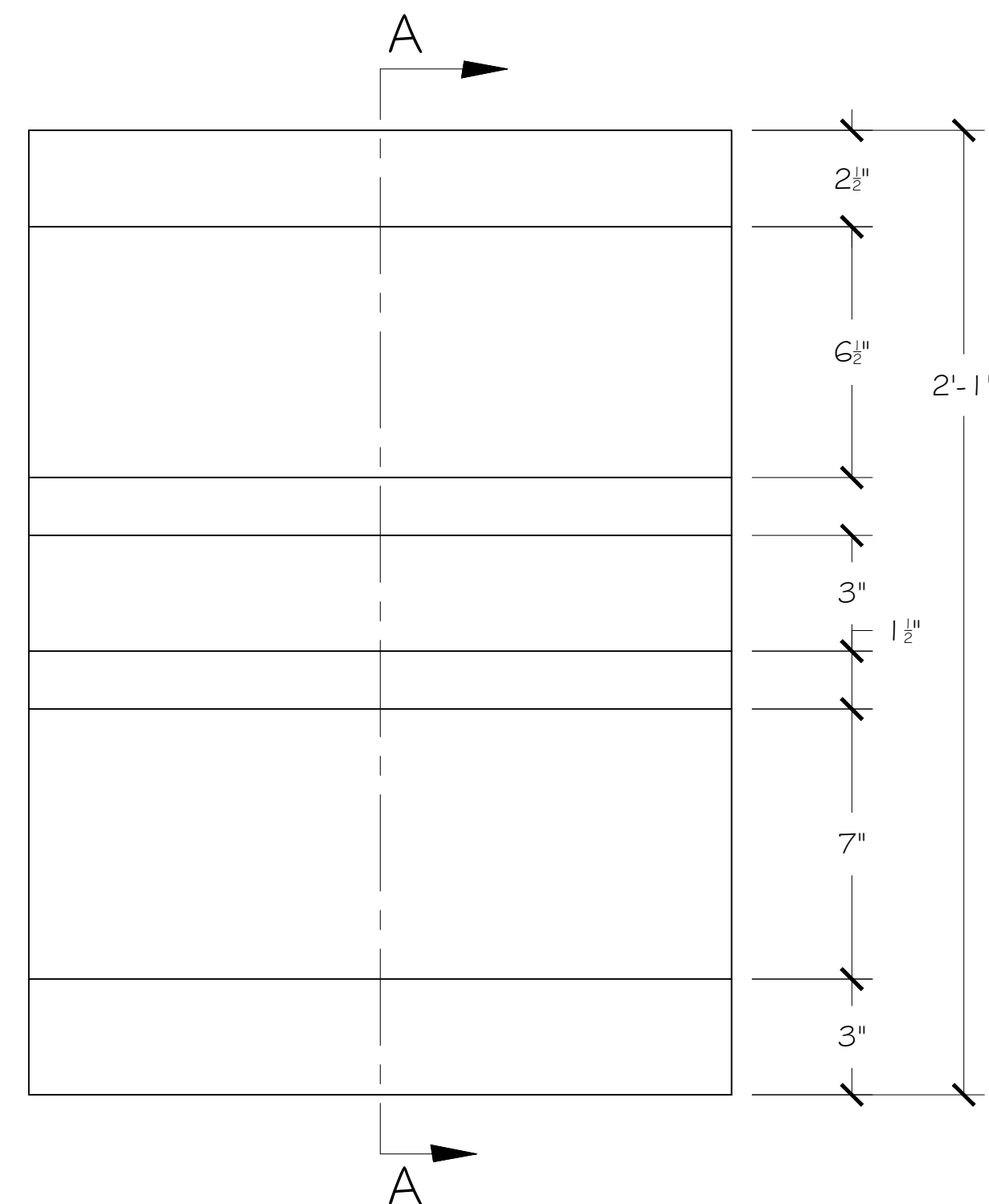

5 DESK FACE A - ELEVATION
SCALE: 3" = 1' - 0"

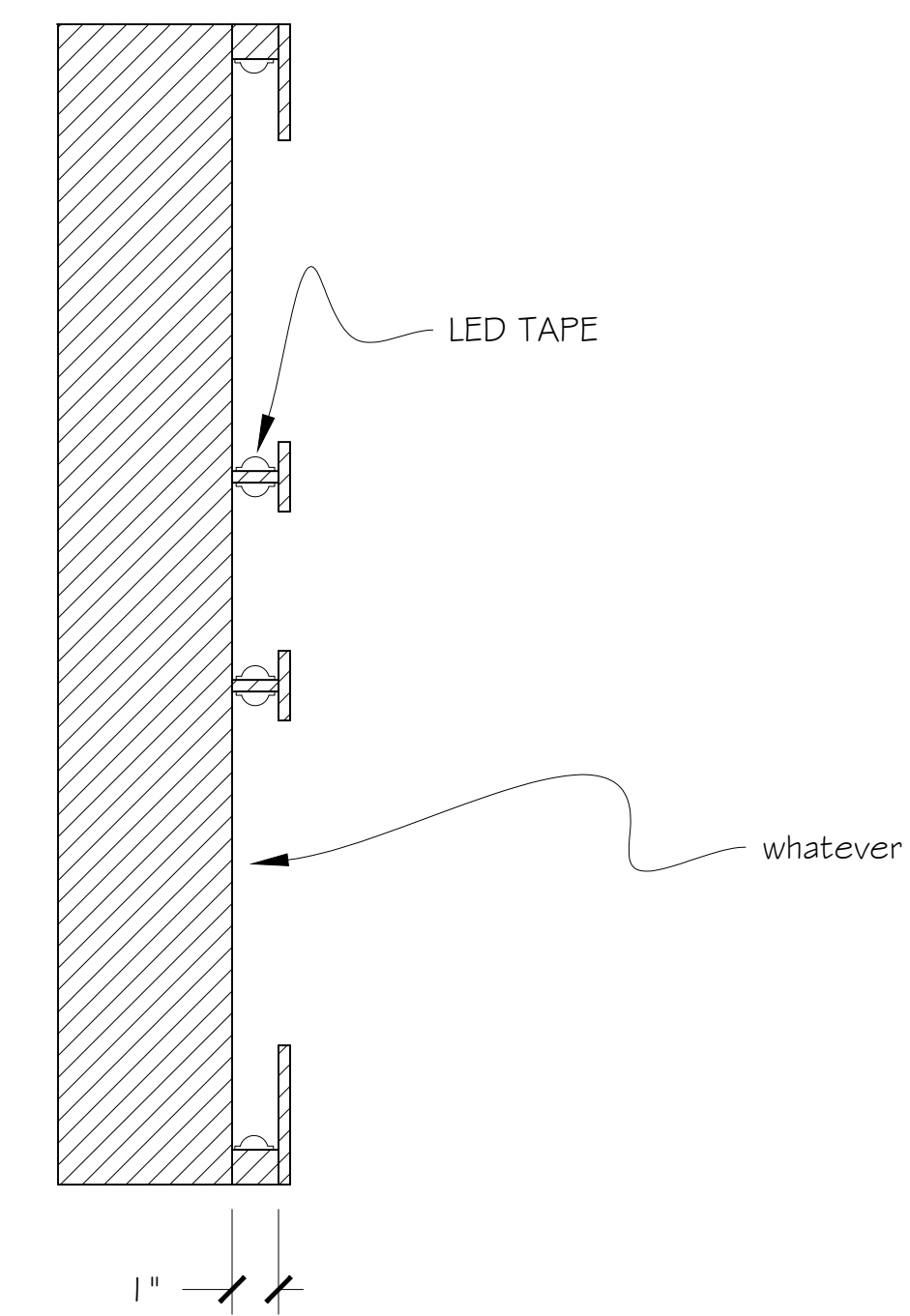

6 DESK FACE - A-A SECTION
SCALE: 3" = 1' - 0"

NOTES:

- 1) DESK IS MOBILE AND CAN BE PLACED ON ANY SURFACE.
- 2) DESK IS STRONG ENOUGH TO SUPPORT WEIGHT OF A SEATED PERSON.
- 3) DESK FACE C SHOULD RFR DESK FACE A.
- 4) MAXIMIZE LEG SPACE, BOTH HEIGHT AND WIDTH.
- 5) CONSIDER OPTION OF OMITTING 2X2 SUPPORTS ON DESK EDGES.
- 6) WORK WITH SDS ON NATURE OF LED TAPE AND SUPPORTS FOR THEM.
- 7) ALLOW SPACE WITHIN DESK FOR LED POWER SUPPLY AND CONTROL.
- 8) APART FROM LAMINATE, ALL SURFACES SHOULD BE FILLED AND SANDED BEFORE PAINTING.

THIS DRAWING REPRESENTS VISUAL CONCEPTS AND CONSTRUCTION SUGGESTIONS ONLY. IT DOES NOT REPLACE THE KNOWLEDGE AND ADVICE OF A LICENSED STRUCTURAL ENGINEER. THE DESIGNER IS UNQUALIFIED TO DETERMINE THE STRUCTURAL APPROPRIATENESS OF THIS DESIGN AND WILL NOT ASSUME RESPONSIBILITY FOR IMPROPER ENGINEERING OR USE.

CONTACT INFORMATION:
EVAN BELSKY 571-224-6699
BELSKY.11@OSU.EDU
BRAD STEINMETZ 614-749-0240
STEINMETZ.25@OSU.EDU



DRAKE 022
BUCKEYE TV STUDIO

DIRECTION: D. FISHER
DESIGN: E. BELSKY
ASST DES: B. STEINMETZ
TECH DIR: C. MAHAN

SCALE:	PLATE:
VARIABLES	7 OF 7
DATE:	REVISION:
02-05-2021	01

DESK